

29

RECEIVED

29 28

SEP 28 1998

WATER RESOURCES DEPT.
SALEM, OREGON

NW 1/4 SE 1/4

NE 1/4 SE 1/4

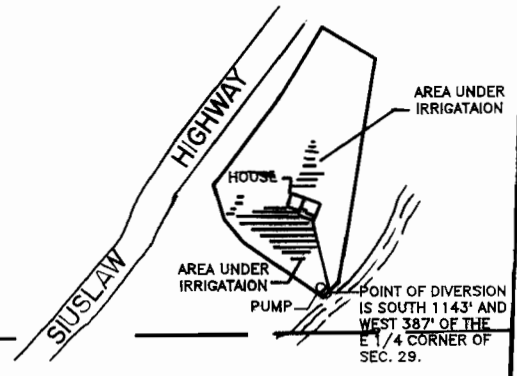

NOTE: AREA IRRIGATED IS 0.5 ACRES.

SW 1/4 SE 1/4

SE 1/4 SE 1/4

THIS MAP IS FOR THE PURPOSE OF IDENTIFYING THE LOCATION OF THE WATER RIGHT ONLY. THERE IS NO INTENT TO PROVIDE DIMENSIONS OR LOCATION OF PROPERTY OWNERSHIP LINES.

29 28
32 33

FINAL PROOF
WATER RIGHTS MAP
UNDER
PERMIT 53288
APPLICATION NO. 71220

17-09-29-4, T.L. 1302
NE 1/4 SE 1/4, SEC 29, T17S, R9W, W.M.
LANE COUNTY, OREGON

FOR: DON McELROY
P.O. BOX 43
SWISSHOME, OREGON 97480

PREPARED BY: WOBBE & ASSOCIATES, INC.
510 KINGWOOD ST. / P.O. BOX 3093
FLORENCE, OR 97439
DATE: JULY 6, 1998



SCALE
1"=400'

