

T. 22S., R. 8W., W.M.

1 INCH = 1320 FEET

RECEIVED

DATE
BY

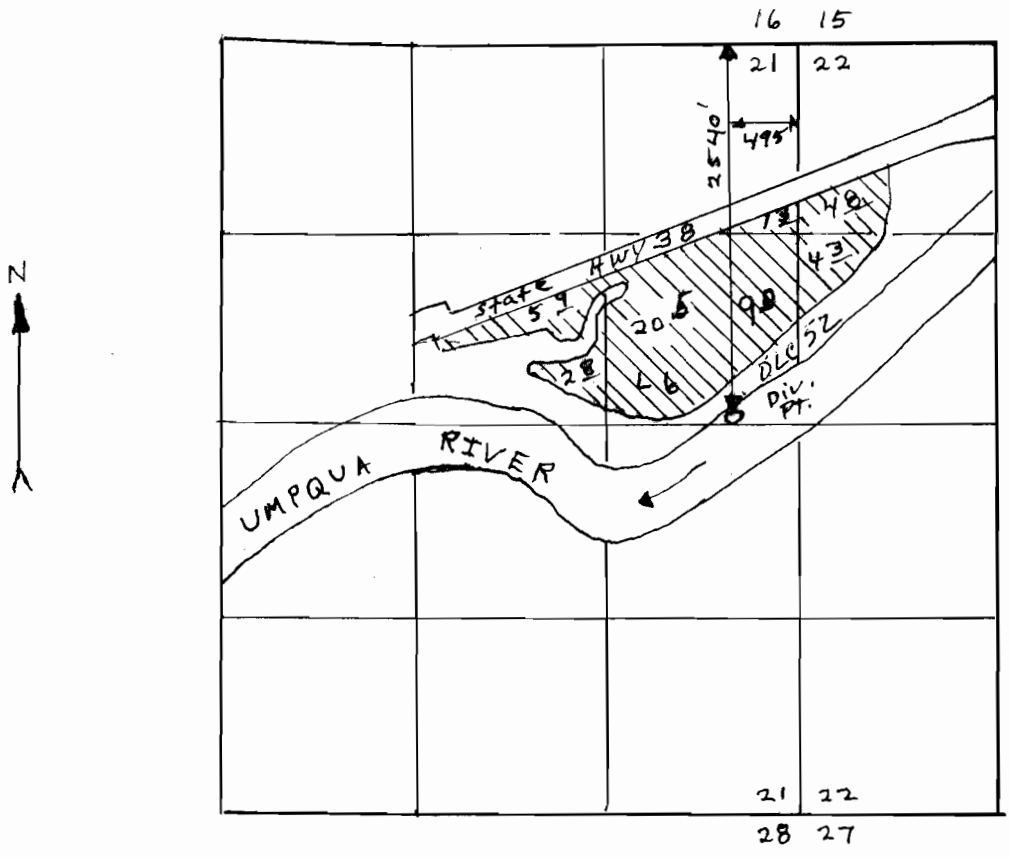

FINAL PROOF SURVEY UNDER

Application No. 70536 Permit No. 51204
IN NAME OF

STEVE BECKLEY

Surveyed MAR 19 1995 by DUANE
KIRBY



THE PURPOSE OF THIS MAP IS TO IDENTIFY THE LOCATION OF THE WATER RIGHT. IT IS NOT INTENDED TO PROVIDE INFORMATION RELATIVE TO THE LOCATION OF PROPERTY OWNERSHIP BOUNDARY LINES.

Amended by WRD Staff 5-5-08 to indicate G20+ & D.C. JWG