

T.7S., R.2W., W.M.

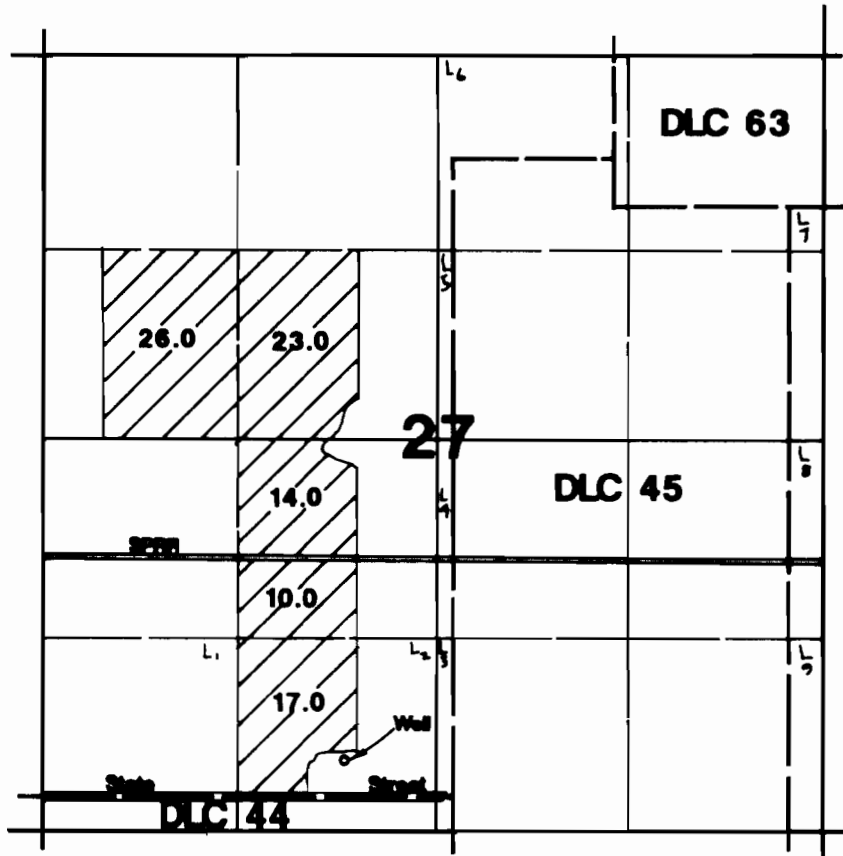

Well located 500'N & 600'W from S 1/4 corner Section 27.

Final Proof Survey

Application #: G-12800 Permit #: G-11677

In Name Of

Clarence Gietema

Surveyed on July 11, 1995 by JM Schuette

RECEIVED

JUL 28 1995

WATER RESOURCES DEPT
SALEM, OREGON

THIS MAP WAS PREPARED FOR THE PURPOSE OF IDENTIFYING THE LOCATION OF A WATER RIGHT ONLY AND IS NOT INTENDED TO PROVIDE LEGAL DIMENSIONS OR LOCATION OF PROPERTY OWNERSHIP LINES.

