

THIS MAP WAS PREPARED FOR THE PURPOSE OF IDENTIFYING THE LOCATION OF THE WATER RIGHT AND IS NOT INTENDED TO PROVIDE LEGAL DIMENSIONS OR LOCATIONS OF PROPERTY OWNERSHIP LINES.

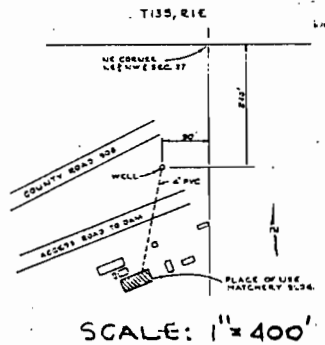

WELL LOCATED 240' S. & 90' W.
FROM N.E. COR. NE 1/4 NW 1/4, SEC. 27
T13S, R1E

**FINAL PROOF SURVEY
UNDER**

APPLICATION NO. G-13436 PERMIT NO. G-11861
IN NAME OF

OREGON DEPARTMENT OF FISH AND WILDLIFE

SURVEYED: 6/3/98 BY: DODGE