

RECEIVED

JUN 03 1997

WATER RESOURCES DEPT.  
SALEM, OREGON

T.5S., R.1W., W.M.

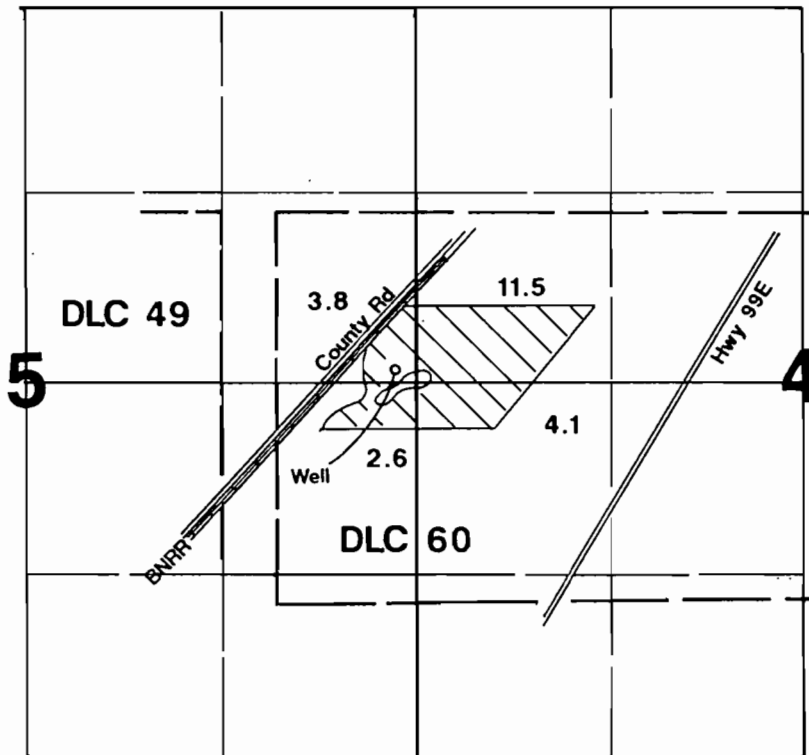

Well located 90'N & 120'W from E 1/4 corner Section #5

Final Proof Survey

Application #: G-12203

Permit #: G-11643

In Name Of

Lucy O'Neal

Surveyed on May 10, 1997 by JM Schuette

THIS MAP WAS PREPARED FOR THE PURPOSE OF IDENTIFYING THE LOCATION OF A WATER RIGHT ONLY AND IS NOT INTENDED TO PROVIDE LEGAL DIMENSIONS OR LOCATION OF PROPERTY OWNERSHIP LINES.

Map amended by WRD 7-31-08 jwg

