

T 6 S, R 3 W, WM

MARION COUNTY, OREGON

RECEIVED

MAR 18 1998

PLANS DEPT
REGON

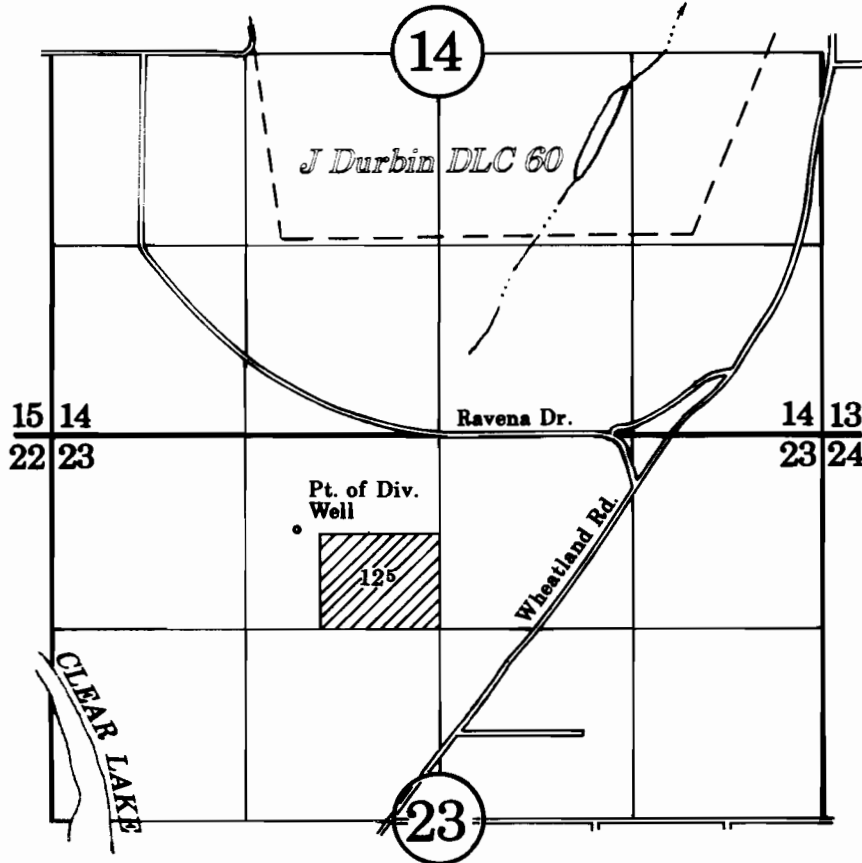

Pt. of Div. : 630' South & 990' West from N 1/4 corner of Section 23

FINAL PROOF SURVEY

UNDER

Application G-13787, Permit G-12300

Bruce R. Chapin

Surveyed: November 26, 1997

Scale: 1" = 1320'



NOTE: This map is for the purpose of indentifying the location of water rights and has no intent to dimension or locate property ownership lines.