

CLAIM OF BENEFICIAL USE MAP  
IN THE NAME OF

GARY D. BORK AND CAROL J. BORK

SE 1/4 of SE 1/4 Section 18, T.6 S., R.1 E., W.M.  
MARION County, Oregon

FINAL SURVEY SEPT. 10, 2000

APPLICATION NO. S-73815 PERMIT NO. R-11599

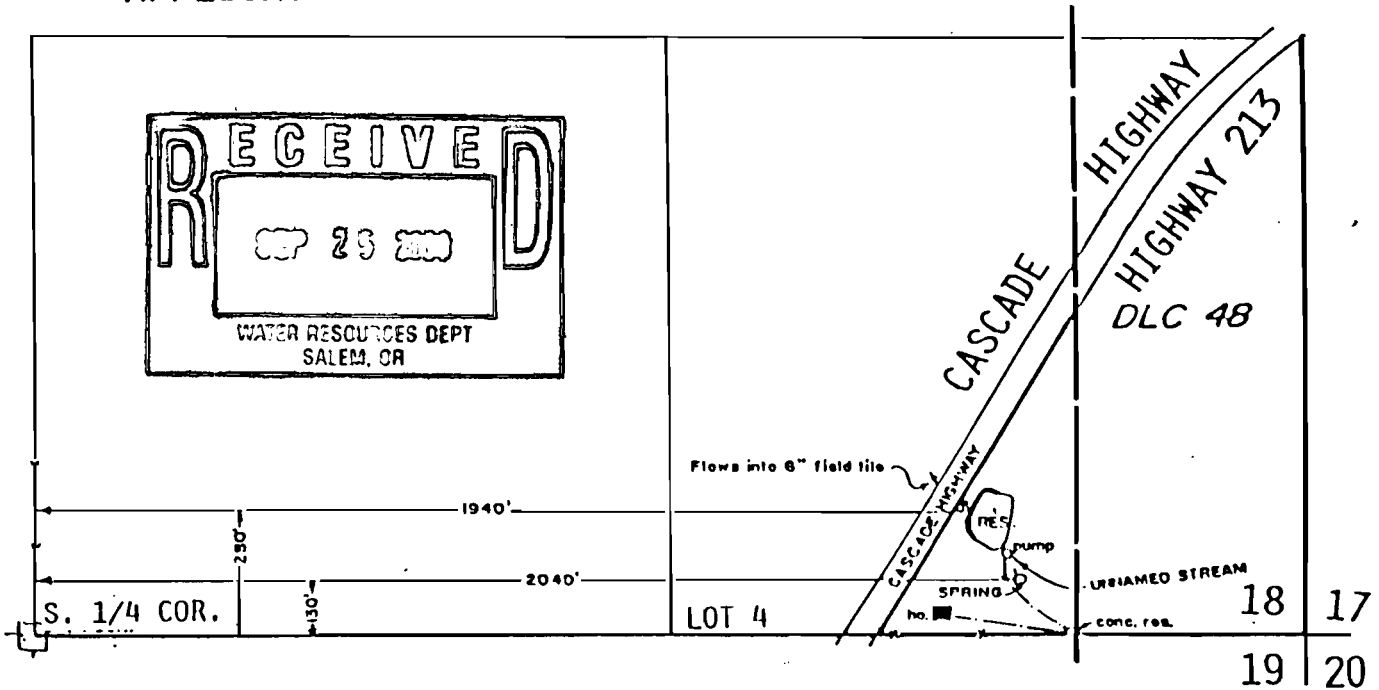

BASE IS ASSESSORS MAP 6S 1 18 AND  
DONALD R. BUELL, CWRE APPLICATION MAP

RESERVOIR IS LOCATED 280 FEET NORTH AND  
1940 FEET EAST OF THE SOUTH 1/4 CORNER  
SECT. 18, T.1 N., R.2 W. OF W.M.

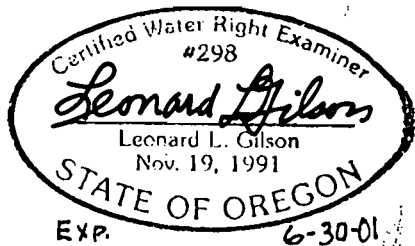

This map is for the purpose  
of locating a water right only  
and has no intent to provide  
legal dimension or the location  
of property lines.



SCALE: 1" = 400'

LEONARD L. GILSON, P.E., P.L.S.  
ENGINEERING - SURVEYING  
7275 SW 82<sup>ND</sup> AVE.  
PORTLAND, OR 97223-7319  
PHONE: (503) 246-1612  
(503) 838-5611