

BOONE RD. S.E.

11 12

14 13

T. 8 S. R. 3 W., W.M.



N



1" = 400'

RECEIVED

SEP 4 1996

STATE OF MISSISSIPPI  
DEPT. OF REVENUE

REGISTERED

1996

FINAL PROOF SURVEY MAP

FOR

APPLICATION NO. G-12427

PERMIT NO. G-11346

IN THE NAME OF

JOHN D. MILLER

SURVEYED ON MARCH 30, 1995

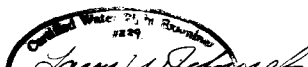
BY:   
LARRY W. BROUSEK  
Dec. 7, 1989  
STATE OF MISSISSIPPI

WELL NO. 1 LOC. 3820'S. & 270'W. FROM NE COR. SEC. 14.

WELL NO. 2 LOC. 3740' S. & 760' E. FROM NE COR. SEC. 14.

14

LN. S.E.

REED

BATTLE CREEK RD. S.E.

LANDAU ST. S.E.

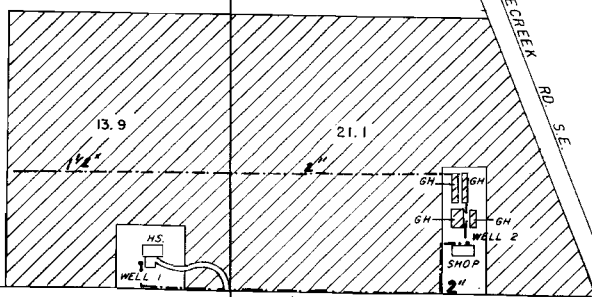

THIS MAP WAS PREPARED FOR THE PURPOSE OF IDENTIFYING THE LOCATION OF A WATER RIGHT ONLY AND IS NOT INTENDED TO PROVIDE LEGAL DIMENSIONS OR LOCATION OF PROPERTY OWNERSHIP LINES.