

RECEIVED

JAN 9 8 2000

WATER RESOURCES DEPT
SALEM, OREGON

T.4S. R.2W. W.M.
MARION COUNTY

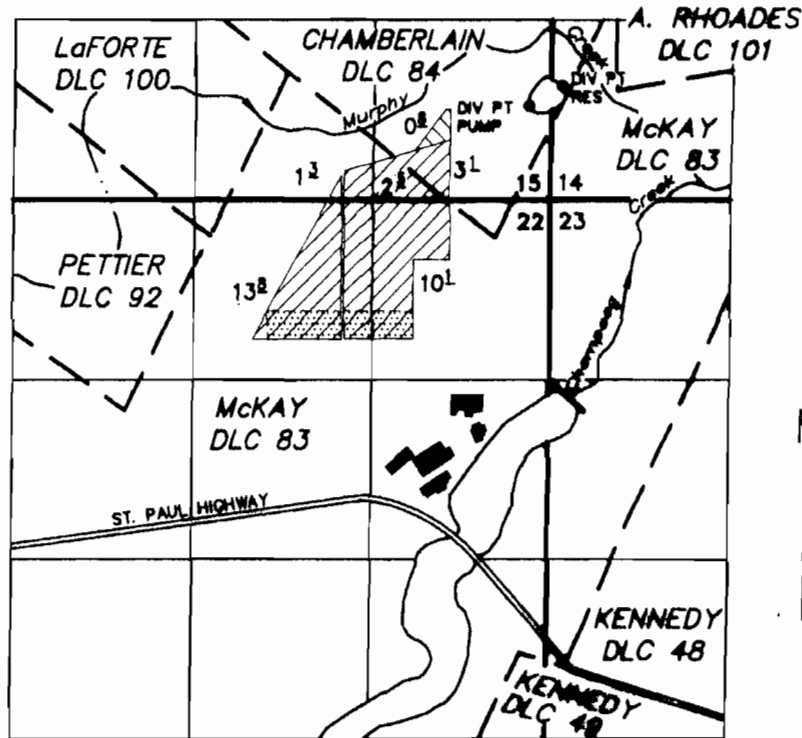



TAX LOTS:
042W22 00100
042W22 00201
042W23 00400

RES DIV PT: 34' N & 402' W FROM THE SW COR OF A. RHOADES DLC 101
PUMP DIV PT: 113' S & 650' W FROM THE SW COR OF A. RHOADES DLC 101

FINAL PROOF SURVEY

UNDER

ALL AREAS 1/40 CFS

 NURSERY OPERATIONS
 GREENHOUSES
 NURSERY OPERATIONS WITH IRRIGATION

GR-2514	R-4964	GR-3833
R-44070	32366	39929
44071	R-11676	39930
R-71953	51962	
S-72042		

Application No. _____ Permit No. _____ Certificate No. _____

A & R SPADA FARMS

SEPTEMBER 14, 1999
rev DECEMBER 4, 2007

SCALE: 1" = 1320'

NOTE: This map is for the purpose of identifying the location of water rights and has no intent to dimension or locate property ownership lines.

