

Township 8 South, Range 5 West, W.M.

Section 7

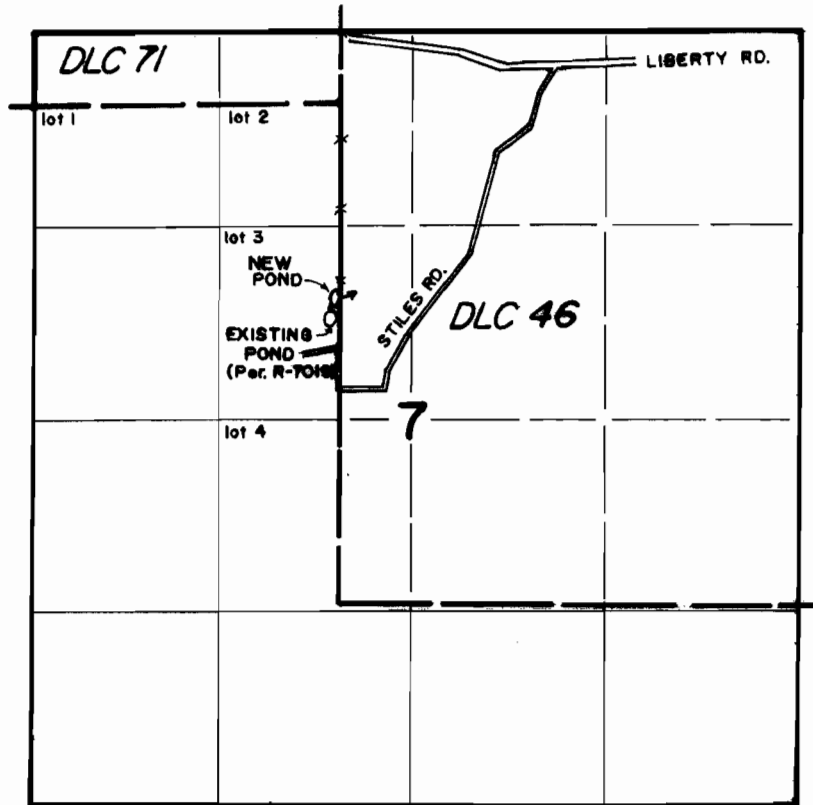

pond located 1340' S. and 5' W. from NE corner lot 2

FINAL PROOF SURVEY

under

Appl. No. R-70627, Per. No. R-11375

In name of

KIM HOFFMAN

August 28, 1995

RECEIVED

SEP 18 1995

WATER RESOURCES DEPT.
SALEM, OREGON

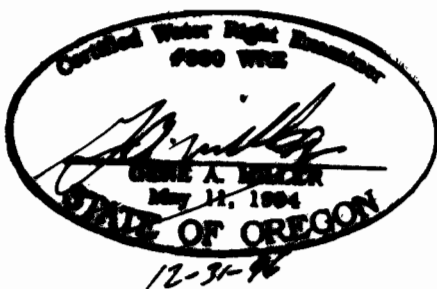

THIS MAP WAS PREPARED FOR THE PURPOSE OF IDENTIFYING THE LOCATION OF A WATER RIGHT ONLY AND IS NOT INTENDED TO PROVIDE LEGAL DIMENSIONS OR LOCATION OF PROPERTY OWNERSHIP LINES.