

T.9S. R.1E. Sec. 15 & 22

JAN 2 2009

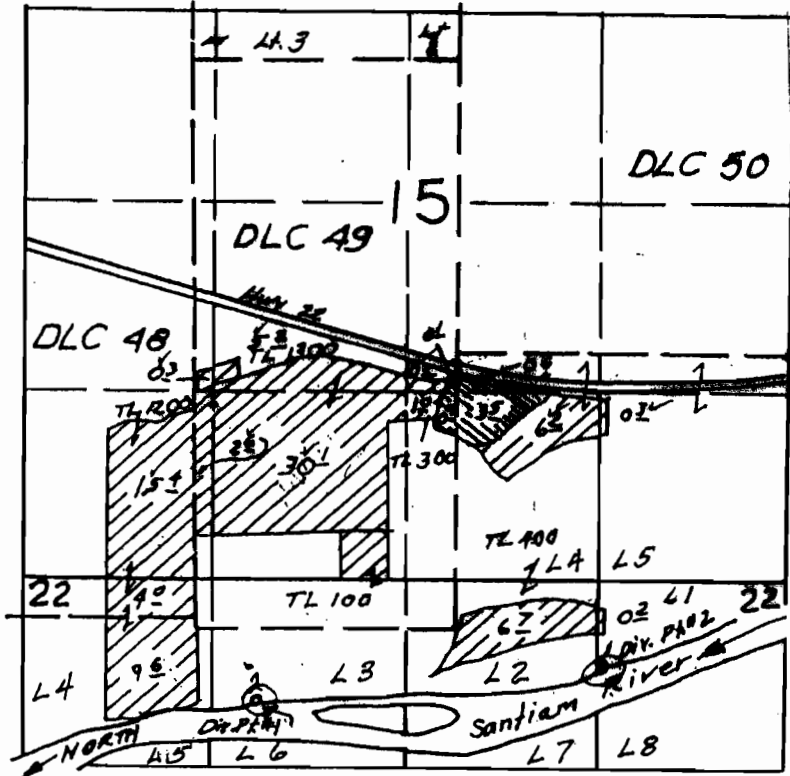

Diversion Point 1 is located 520 feet south and 400 feet east of the southwest corner of Stout DLC 49.
 Diversion Point 2 is located 250 feet south and 2770 feet east of the southwest corner of Stout DLC 49.



Area (5.1 Acres) irrigated from the North Santiam River from March 1 to June 30 as a primary water right, with stored water rights supplemental during this time period. Stored water from Detroit Reservoir under R-1625 are primary from July 1 through October 31.



Area (82.1 Acres) irrigated from the North Santiam River from March 1 to June 30 as a primary water right. Existing water rights (Permits S-31373, S-32464, and S-47553) for stored water are supplemental during this time period.

*Amended to add gov't lot numbers
 5/2/07 LHN, OWRD*



EXPIRATION DATE: 6/30/03

This map was prepared for the purpose of identifying the location of a water right only and is not intended to provide legal dimensions or location of property ownership lines.

Scale: 1" = 1,320'



0 1,320 Feet

Pacific Hydro-Geology Inc.

Claim of Beneficial Use Map

Application No. S-80916 and Permit No. S-53184
 Mark and Jolly Krautman
 T.9 S. R.1E. Sec. 15 & 22