

TOWNSHIP 1 SOUTH, RANGE 12 EAST, W.M.

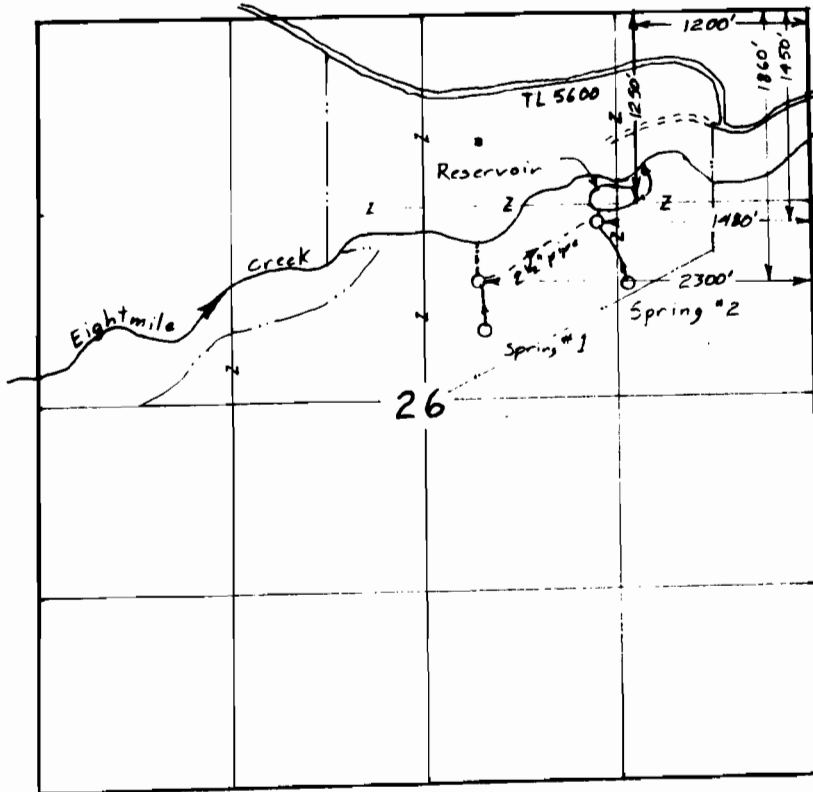

Scale 1" = 1320'

Surveyed August 23, 1994

App R-75034
 Per R-11930
 & App S-75033
 Per 52630

Claim of Beneficial Use Map
 for
 WILLIAM S. & PENNY RITCHIE

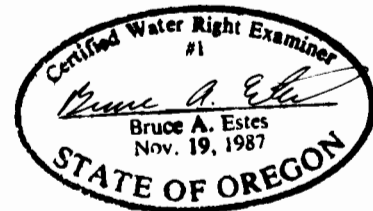

RECEIVED

OCT 27 1997

**WATER RESOURCES DEPT.
 SALEM, OREGON**

This map is for the purpose of
 locating a water right only
 and has no intent to provide
 legal dimensions or the location
 of property lines.

ESTES SURVEYS

6293 Sunnyview Rd. NE 60382 Arnold Rd.
 Salem, OR 97305 Bend, OR 97702
 (503) 585-7593 (503) 382-7391