

RECEIVED

OCT 09 1995

STATE ENGINEER DEPT. OF TRANSPORTATION  
SALEM, OREGON

T. 5 S., R. 2 W., W. M.  
Section 2



Scale: 1" = 1320'

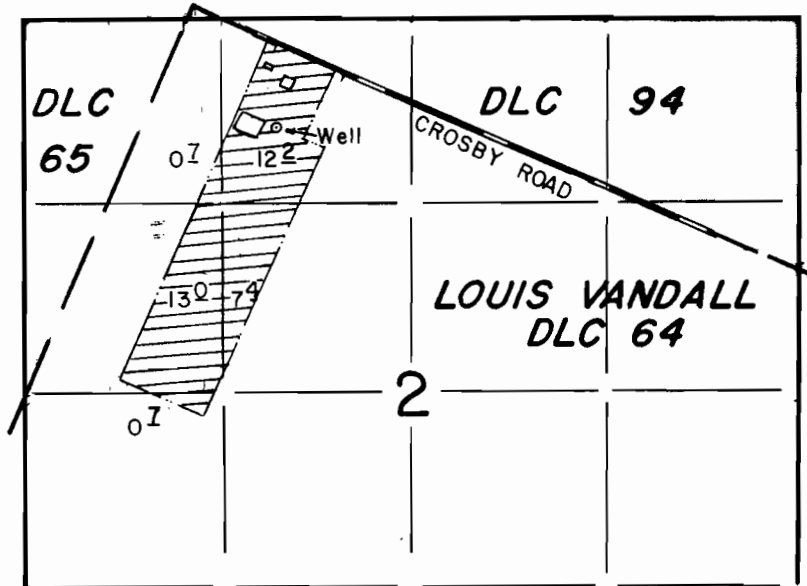

Well Loc.: 840' S. & 550' E. from NW Cor. DLC 64

FINAL PROOF SURVEY  
UNDER

A # G-11235

P# G-11875

IN NAME OF

Dr. CLEON L. & BENNE B. MILLER

SURVEYED AUG. 24, 1995 by T. M. Warren

THIS MAP WAS PREPARED SOLELY FOR  
THE PURPOSE OF DEPICTING THE LOCATION  
OF A WATER RIGHT, AND HAS NO INTENTION  
OF BEING USED TO DETERMINE REAL  
PROPERTY BOUNDARIES.

