

T.5S., R.1W., W.M.

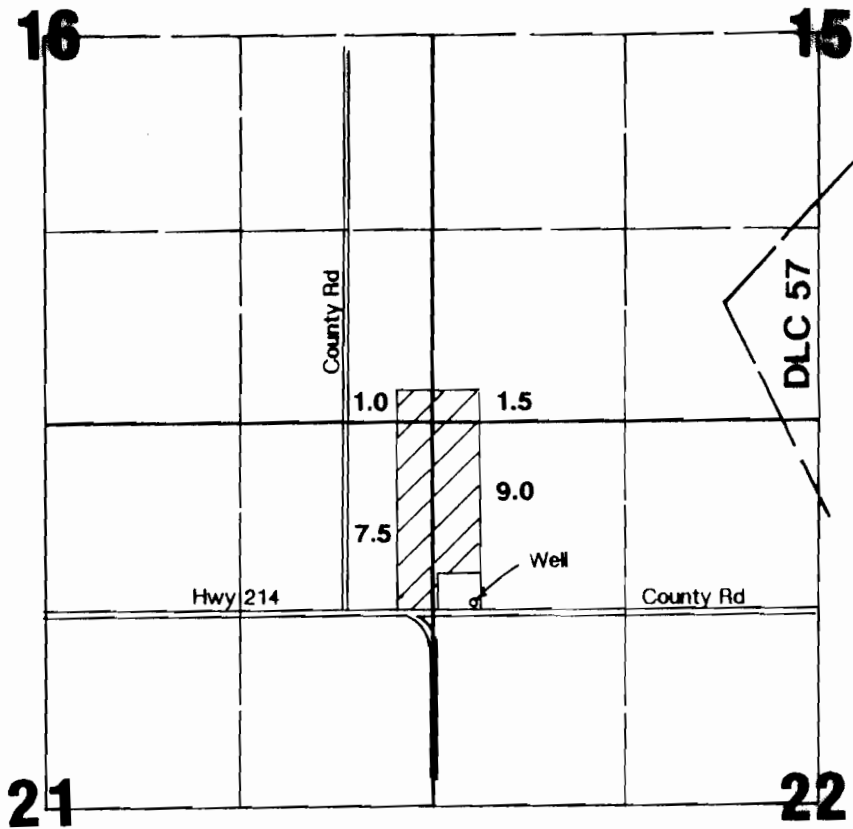

Well located 1250'S & 280'E from NW corner Section 22.

RECEIVED

OCT 25 1995

WATER RESOURCES DEPT.
SALEM, OREGON

1" = 1320'



Area Irrigated

Final Proof Survey

Application #: G-12445 Permit #: G-11468

In Name Of

Bernhard Hitz

Surveyed on October 12, 1995 by JM Schuette

THIS MAP WAS PREPARED FOR THE PURPOSE OF IDENTIFYING THE LOCATION OF A WATER RIGHT ONLY AND IS NOT INTENDED TO PROVIDE LEGAL DIMENSIONS OR LOCATION OF PROPERTY OWNERSHIP LINES.

