

T30S R5W WM

**RECEIVED**

OCT - 6 1997

WATER RESOURCES DEPT.  
SALEM, OREGON

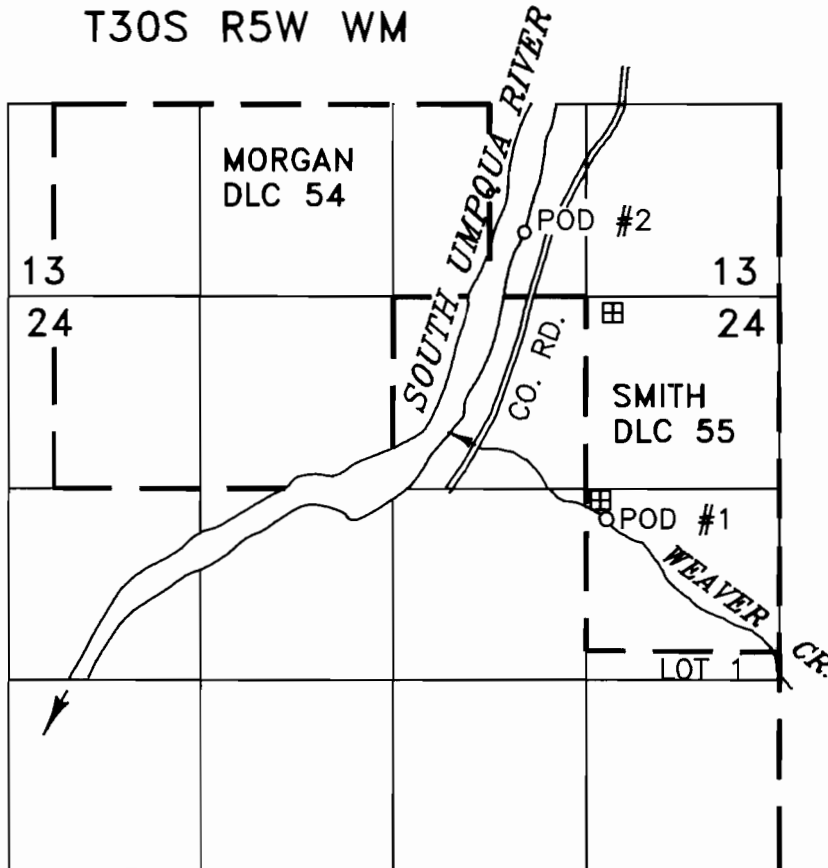

☒ DENOTES STOCK WATER USE

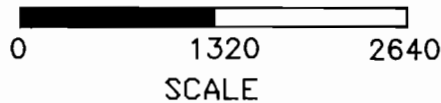

THIS MAP IS TO  
BE USED FOR  
WATER RIGHT  
PURPOSES ONLY

POD #1 IS 1530 FEET SOUTH AND 1180 FEET WEST FROM THE S.E. CORNER OF SECTION 13  
POD #2 IS 440 FEET NORTH AND 1740 FEET WEST FROM THE S.E. CORNER OF SECTION 13

# FINAL PROOF SURVEY

IN THE NAME OF *Robert Sherman*

APPLICATION NO. 72234

PERMIT NO. 52771

BY: WILLIAM J. RUPPERT  
P.O. BOX 1564  
MYRTLE CREEK, OR 97457

INSPECTED MAY 5, 1995

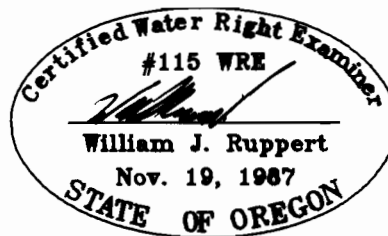

*Amended by WED Staff, 6-12-08 jwg*