

T. 4 N. , R. 1 W. , W. M.
COLUMBIA COUNTY, OREGON

LOCATED IN THE S1/2, SEC. 29 & N1/2, SEC. 32, T. 4 N., R. 1 W., W. M.

RECEIVED

MAR 22 1995

WATER
 SALEM, OREGON

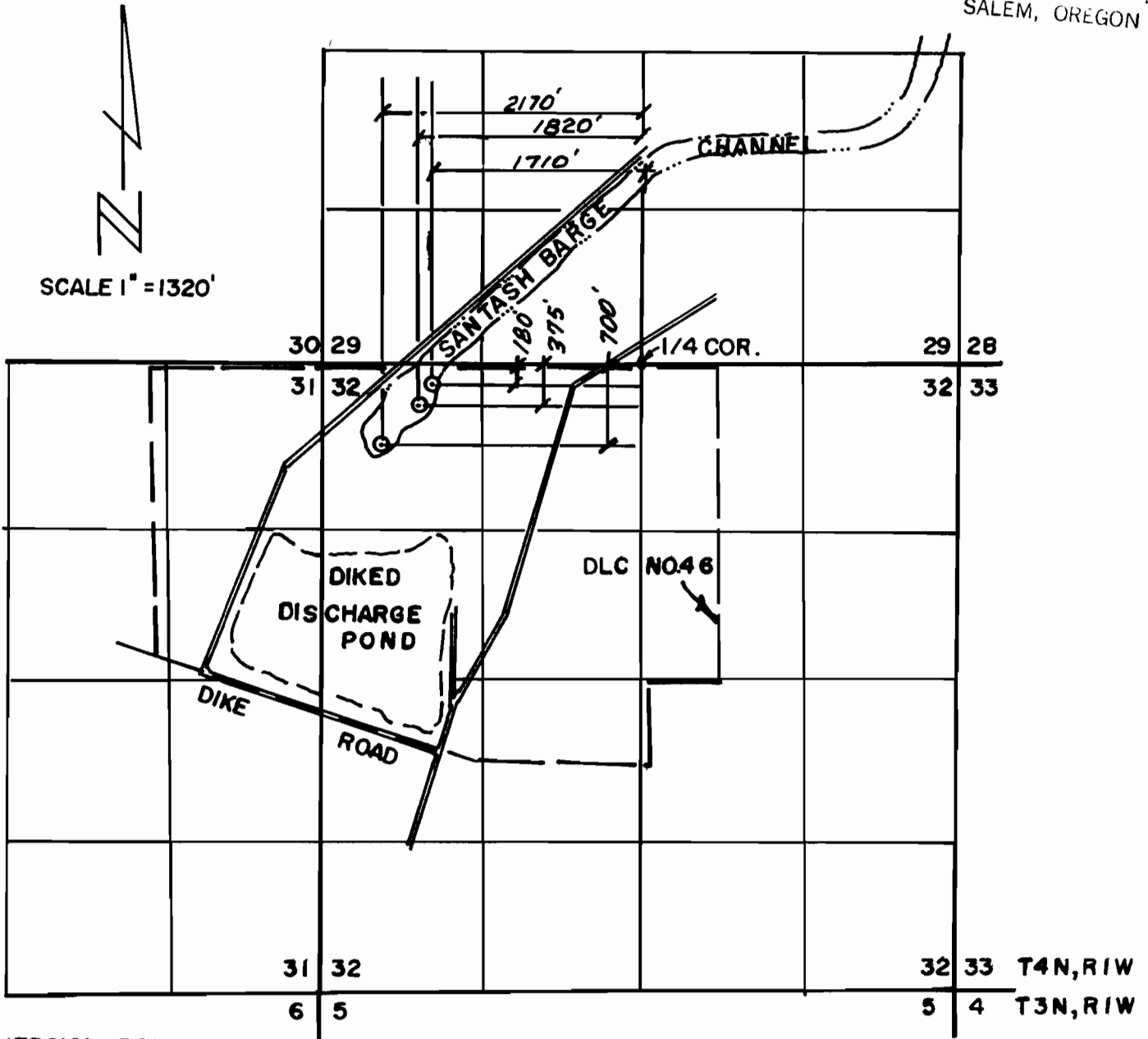

⊙ DIVERSION POINT

FINAL PROOF SURVEY

UNDER

APPLICATION NO. 69840 PERMIT NO. 51417

IN THE NAME OF

OREGON CITY LEASING COMPANY

SURVEYED DECEMBER 13, 1994

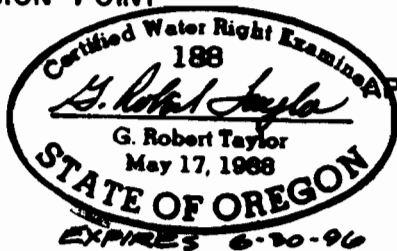

NOTE: THIS MAP WAS PREPARED FOR THE PURPOSE OF IDENTIFYING THE LOCATION OF WATER RIGHTS ONLY AND HAS NO INTENT TO PROVIDE DIMENSIONS OR LOCATION OF PROPERTY OWNERSHIP LINES.

PREPARED BY: ROBERT E. MEYER CONSULTANTS, INC.

4915 S.W. GRIFFITH DRIVE, NO. 300

BEAVERTON, OREGON 97005

PHONE (503) 643-7531

PROJECT NO. 1730-00