

Map of
Lundy Ditch in Sections 4th & 5th
T36S R14E W.M.

5741
8490

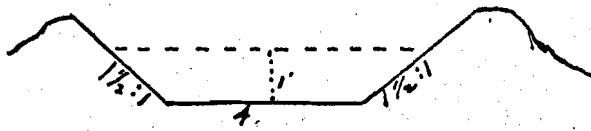
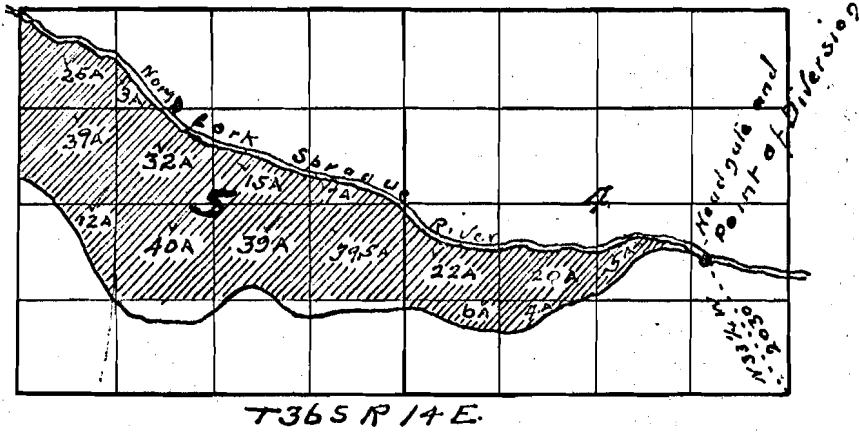

Cross section Canal.

STATE ENGINEER
RECEIVED

NOV 20 1922

SALEM, OREGON

I, E. B. Henry, of Klamath Falls, Ore. do hereby certify that this map was made from notes taken during an actual survey made by me on the 1st day of October 1922, and that it correctly represents the works described in the accompanying application together with the streams and other ditches in the immediate vicinity.

E. B. Henry Surveyor.

This map made under my direction

C. T. Darley
Surveyor

N. H. Sprague R. & Mice.