

**Application for a Water Right Transfer**  
**Location of Parts of Water Rights Not Affected by the Proposed Transfer**  
**Certificates 19882 and 28340**  
**Township 20 South, Range 3 West (W.M.)**

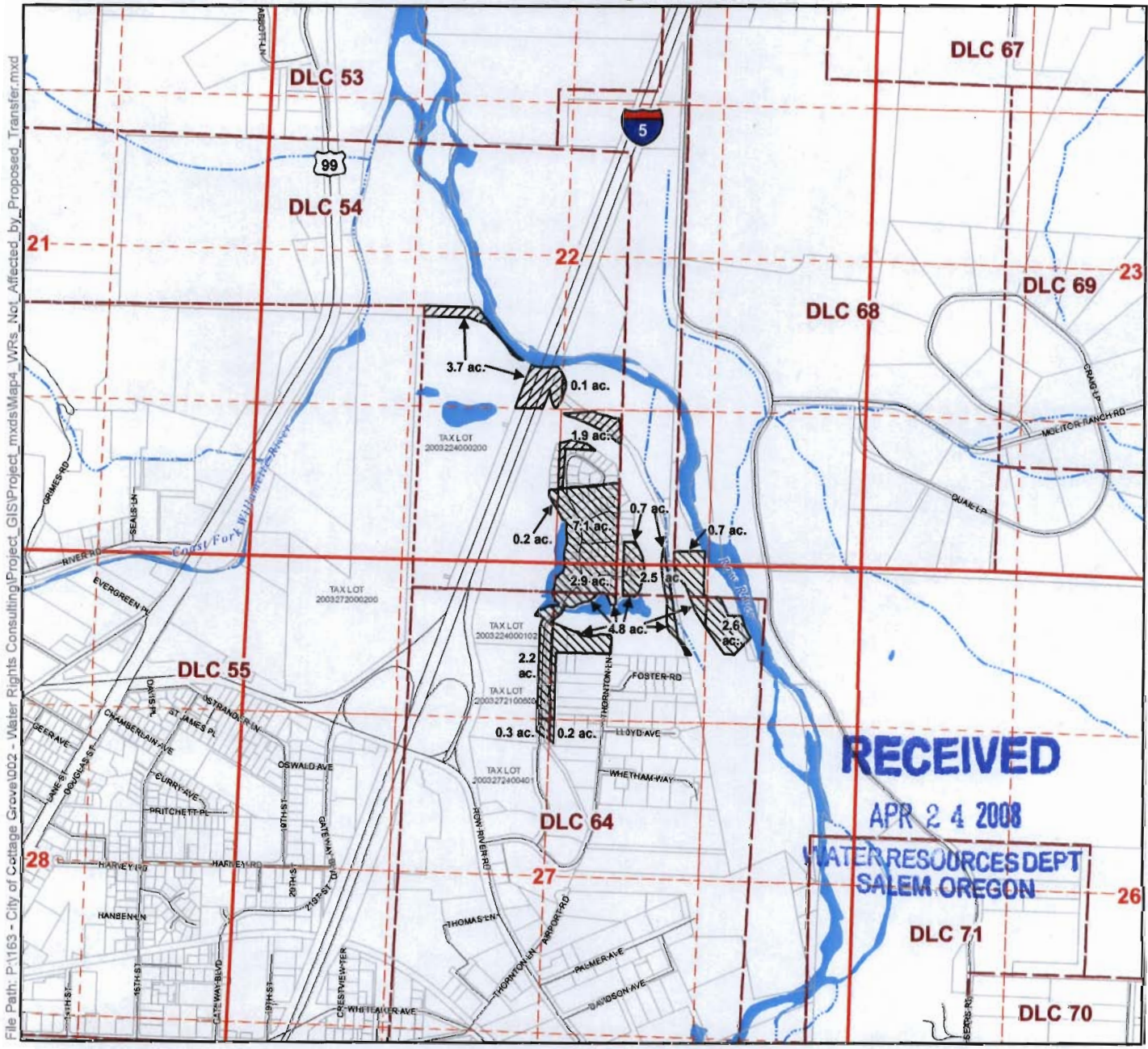

- Legend**
- Remaining Water Rights**
- Cert. 19882 (5.7 ac.)
  - Cert. 28340 (24.2 ac.)
  - Tax Lots
  - Roads
  - Waterbodies
  - Watercourses

**Map Information**  
 Projection: Oregon State Plane South Zone  
 Datum: North American Datum of 1983  
 Date: March 10, 2008  
 Prepared By: GSI Water Solutions, Inc.

**Data Sources**  
 OWRD, LCOG, Oregon Geospatial Data Clearinghouse

**Disclaimer**  
 This map was prepared for the purpose of identifying the location of a water right only and it is not intended to provide legal dimensions or location of property ownership lines.

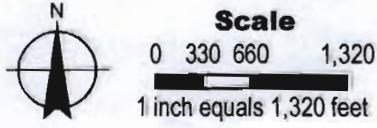

T 10615



**Application for a Water Right Transfer**  
**Authorized Places of Use and Points of Diversion**  
**Certificates 19882 and 28340**  
**Township 20 South, Range 3 West (W.M.)**

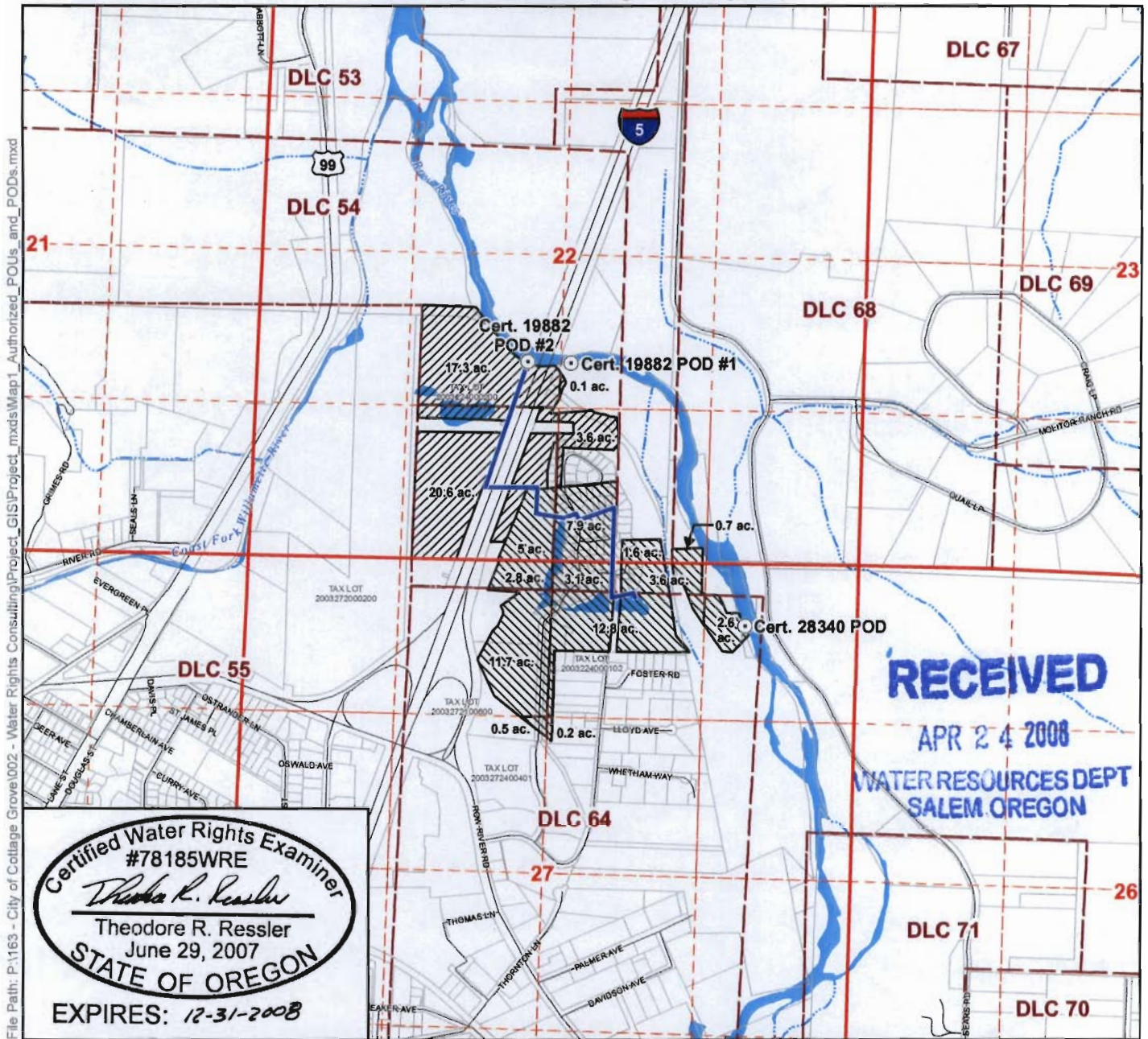

File Path: P:\1163 - City of Cottage Grove\002 - Water Rights Consulting\Project\_GIS\Project\_mxd\Map1\_Authorized\_POUs\_and\_PODs.mxd

**Certified Water Rights Examiner**  
**#78185WRE**  
*Theodore R. Ressler*  
**Theodore R. Ressler**  
 June 29, 2007  
**STATE OF OREGON**  
 EXPIRES: 12-31-2008

**Legend**

**Authorized Place of Use (POU)**

- Cert. 19882 (41.6 ac.)
- Cert. 28340 (52.5 ac.)

- Authorized Points of Diversion (POD)
- Existing Mainline
- Tax Lots
- Roads
- Waterbodies
- Watercourses

**POD Legal Descriptions**

- Cert. 19882 POD #1**  
 As Stated On Certificate: Located in the NW1/4 SE1/4, as Projected on H.C. Veatch DLC 54, Section 22, Township 20 South, Range 3 West (W.M.)
- Cert. 19882 POD #2**  
 As Stated On Certificate: Located in the NE1/4 SW1/4, as Projected on H.C. Veatch DLC 54, Section 22, Township 20 South, Range 3 West (W.M.)
- Cert. 28340 POD**  
 As Stated On Certificate: Located in the NE1/4 NE1/4, as Projected Within Partin DLC 64, Section 27, Township 20 South, Range 3 West (W.M.)

**Map Information**  
 Projection: Oregon State Plane South Zone  
 Datum: North American Datum of 1983  
 Date: March 10, 2008  
 Prepared By: GSI Water Solutions, Inc.

**Data Sources**  
 OWRD, LCOG, Oregon Geospatial Data Clearinghouse

**Disclaimer**  
 This map was prepared for the purpose of identifying the location of a water right only and it is not intended to provide legal dimensions or location of property ownership lines.

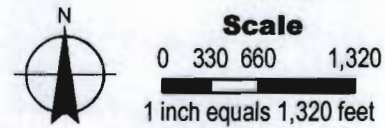

T 10615