

Section 16 Township 24 s Range 12 W W.M.
 Located in the E 1/2 of the SE 1/4
 Coos County

CS 1/4

SECTION 16 ONLY
 E 1/4
 P.O.B.

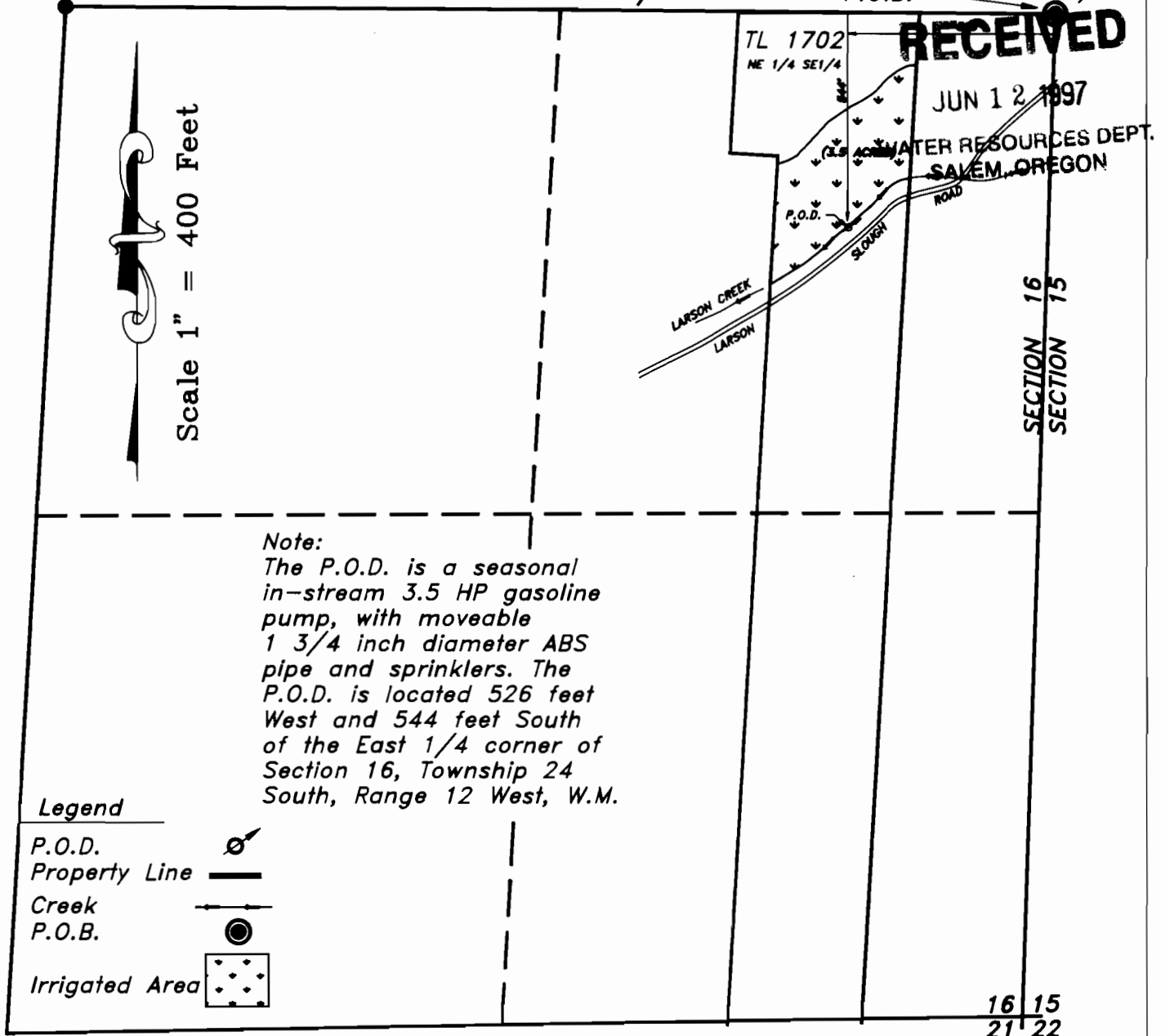

Note:
 The P.O.D. is a seasonal in-stream 3.5 HP gasoline pump, with moveable 1 3/4 inch diameter ABS pipe and sprinklers. The P.O.D. is located 526 feet West and 544 feet South of the East 1/4 corner of Section 16, Township 24 South, Range 12 West, W.M.

Legend

- P.O.D.
- Property Line
- Creek
- P.O.B.
- Irrigated Area

EXAMINERS DISCLAIMER STATEMENT

NOTE:
 The P.O.D. and Waterline is entirely located on property owned by the applicant.

The preparation of this map was for the purpose of identifying the location of the Water Right only and has no intent to provide dimensions or location of property ownership lines.



FINAL PROOF SURVEY

Prepared For: John Cheslock
 Prepared By: Dennis Goude
 Surveyed: July 31, 1996

Application No. S-70237
 Permit No. 51720