

T.1S., R.4E., W.M.

RECEIVED

OCT 01 1996

WATER RESOURCES DEPT
SALEM OREGON

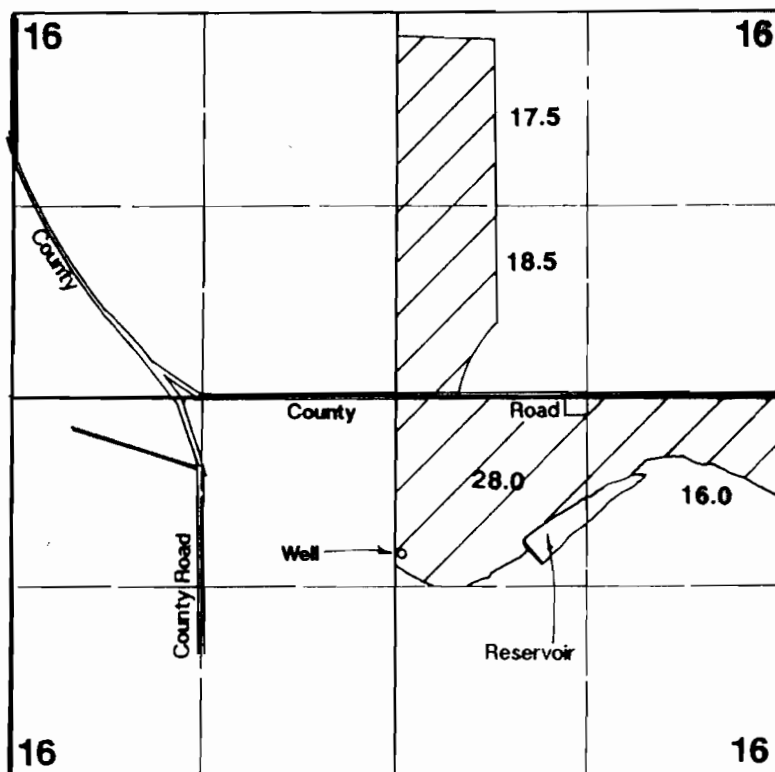

1" = 1320'

Area Irrigated

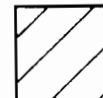

Well located 1070'S & 50'E from center Section 16.

Final Proof Survey

Application #: G-12635 Permit #: G-11445

In Name Of

Sester Farms, Inc.

Surveyed on September 19, 1996 by JM Schuette

THIS MAP WAS PREPARED FOR THE PURPOSE OF IDENTIFYING THE LOCATION OF A WATER RIGHT ONLY AND IS NOT INTENDED TO PROVIDE LEGAL DIMENSIONS OR LOCATION OF PROPERTY OWNERSHIP LINES.

