

T.5S. R.1E. W.M.

CLACKAMAS COUNTY

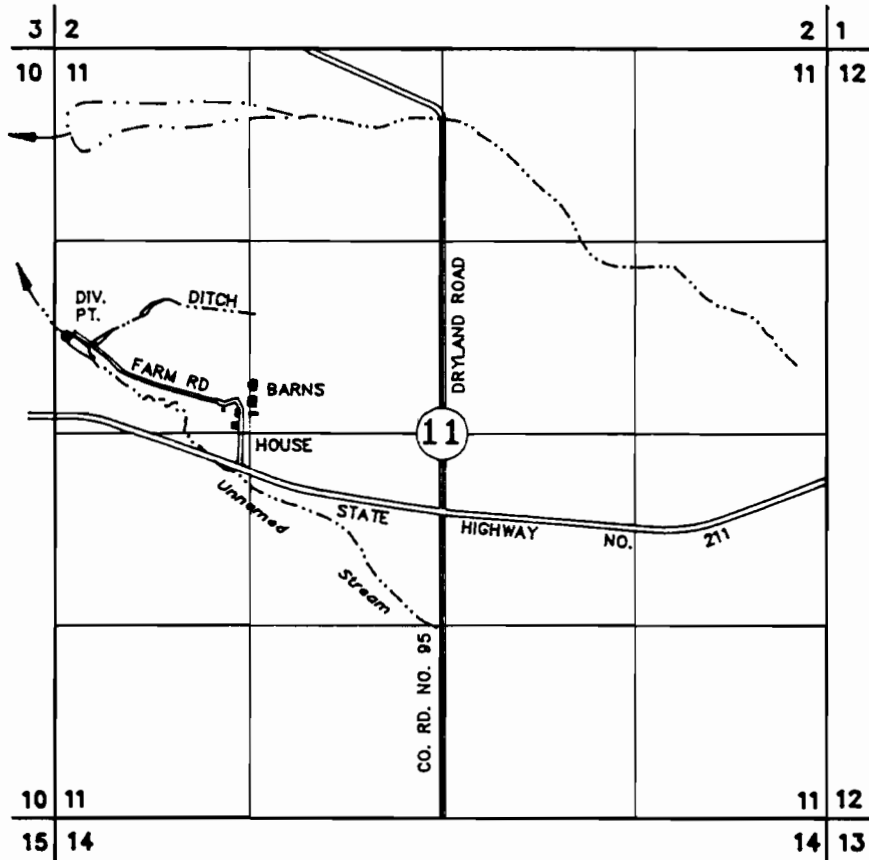

DIV. PT.: 665' NORTH AND 2560' WEST OF THE CENTER OF SECTION 11.

RECEIVED

SEP 29 1989

**WATER RESOURCES DEPT.
SALEM, OREGON**

FINAL PROOF SURVEY

UNDER

Application No. R-72613 Permit No. R-11581
S-72614 51704

LOWELL FARMER

AUGUST 11, 1999
SCALE 1" = 1320'

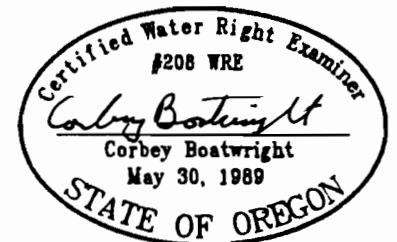

NOTE: This map is for the purpose of identifying the location of water rights and has no intent to dimension or locate property ownership lines.