

AVION WATER CO, INC.
PLACE OF USE
 APPLICATION G-12884, PERMIT G-12788
 PERMIT ASSIGNMENTS T-7778; T-10487
 DEBONVILLE COUNTY

RECEIVED

JUN 25 2008



WATER RESOURCES DEPT
 SALEM, OREGON



1 inch equals 10,560 feet



DRAWN BY: TRACER LINDSON
 AVION WATER CO. DEPARTMENT
 MARCH 2008

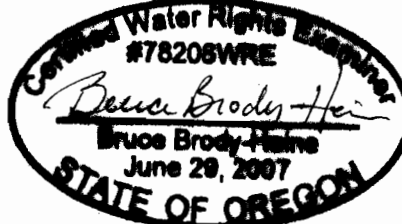

NOTE:
 REFER TO THE OVERVIEW MAP
 IN ATTACHMENT 1 FOR
 TAX LOT INFORMATION.

 This Qtr/Qtr is not part
 of the POU.

 PLACE OF USE

DISCLAIMER:
 This map was prepared for the purpose
 of identifying the location of water rights
 only and is not intended to provide legal
 dimensions or locations of property
 ownership lines.

EXPIRES: 12-31-09



AVION WATER CO, INC.

CLAIM OF BENEFICIAL USE - WELL LOCATION MAP

Application G-12884, Permit G-12788
Permit Amendments T-7778; T-10487
Deschutes County

T18S R13E

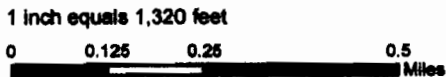
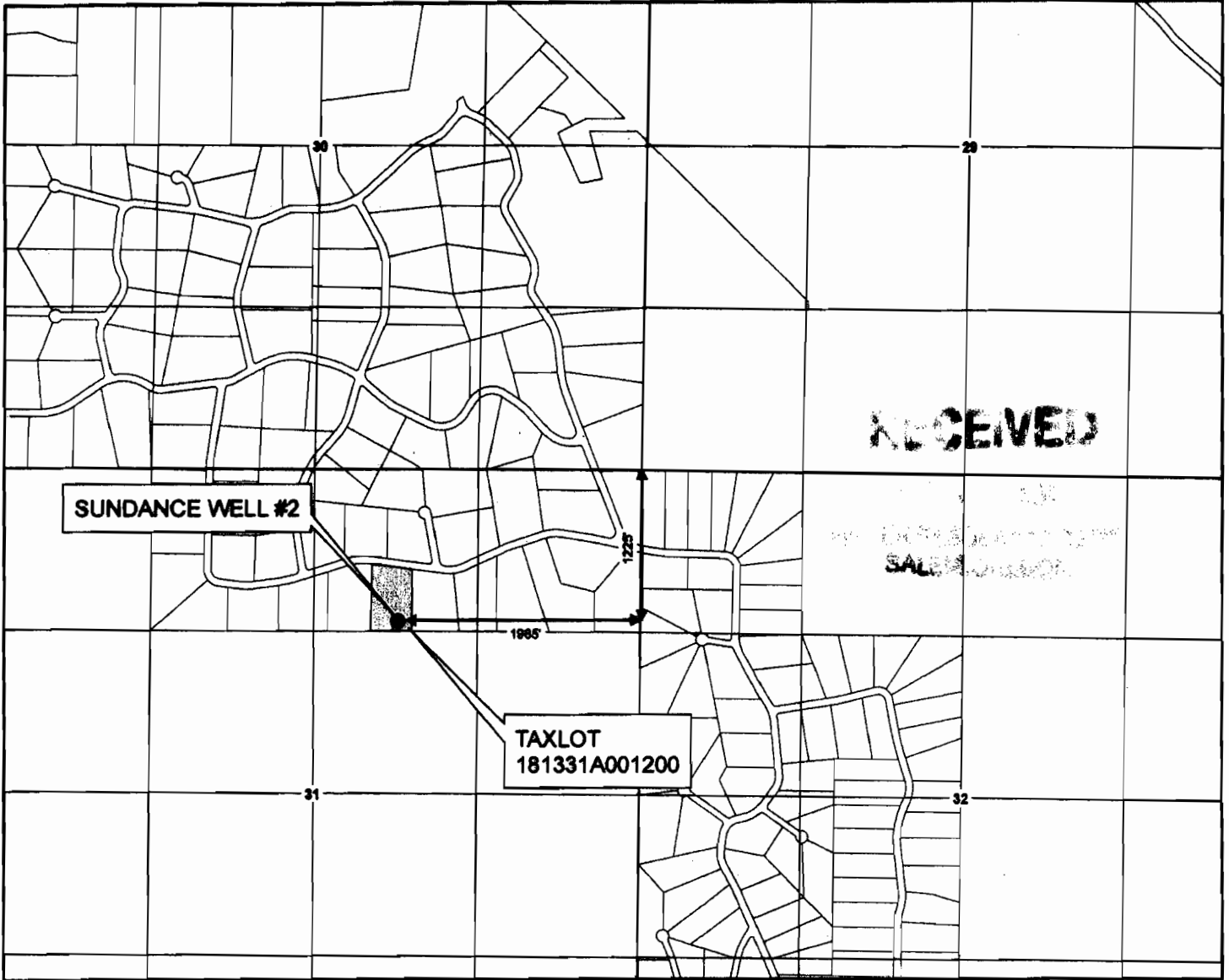

DRAWN BY: TANNER LEMMON
AVION WATER GIS DEPARTMENT
MARCH, 2008

DISCLAIMER:
This map was prepared for the purpose of identifying the location of water rights only and is not intended to provide legal dimensions or locations of property ownership lines.

Legend

- POINT OF APPROPRIATION
- WELL SITE

WELL DESCRIPTION

SUNDANCE WELL #2 (WELL N-2) -
NW 1/4, NE 1/4 of
Section 31, T 18 S, R 13 E,
WM - 1225' South and 1985'
West from the NE corner of
Section 31
Taxlot - 181331A001200

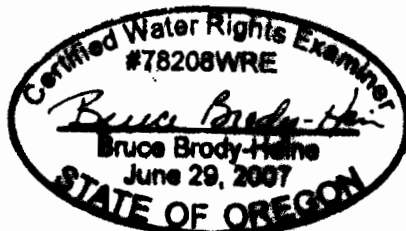

EXPIRES: 12/31/08

NOTES:

Measuring devices:
Refer to Attachment 6

Conveyance System:
Refer to the overview map in
Attachment 1

Base Layer:
Deschutes County Taxlot Shapefile
Projected Coordinate System :
NAD 1983 StatePlane Oregon South
Geographic Coordinate System :
GCS North American 1983



AVION WATER CO, INC.

CLAIM OF BENEFICIAL USE - WELL LOCATION MAP

Application G-12884, Permit G-12788
Permit Amendments T-7778; T-10467
Deschutes County

T18S R12E

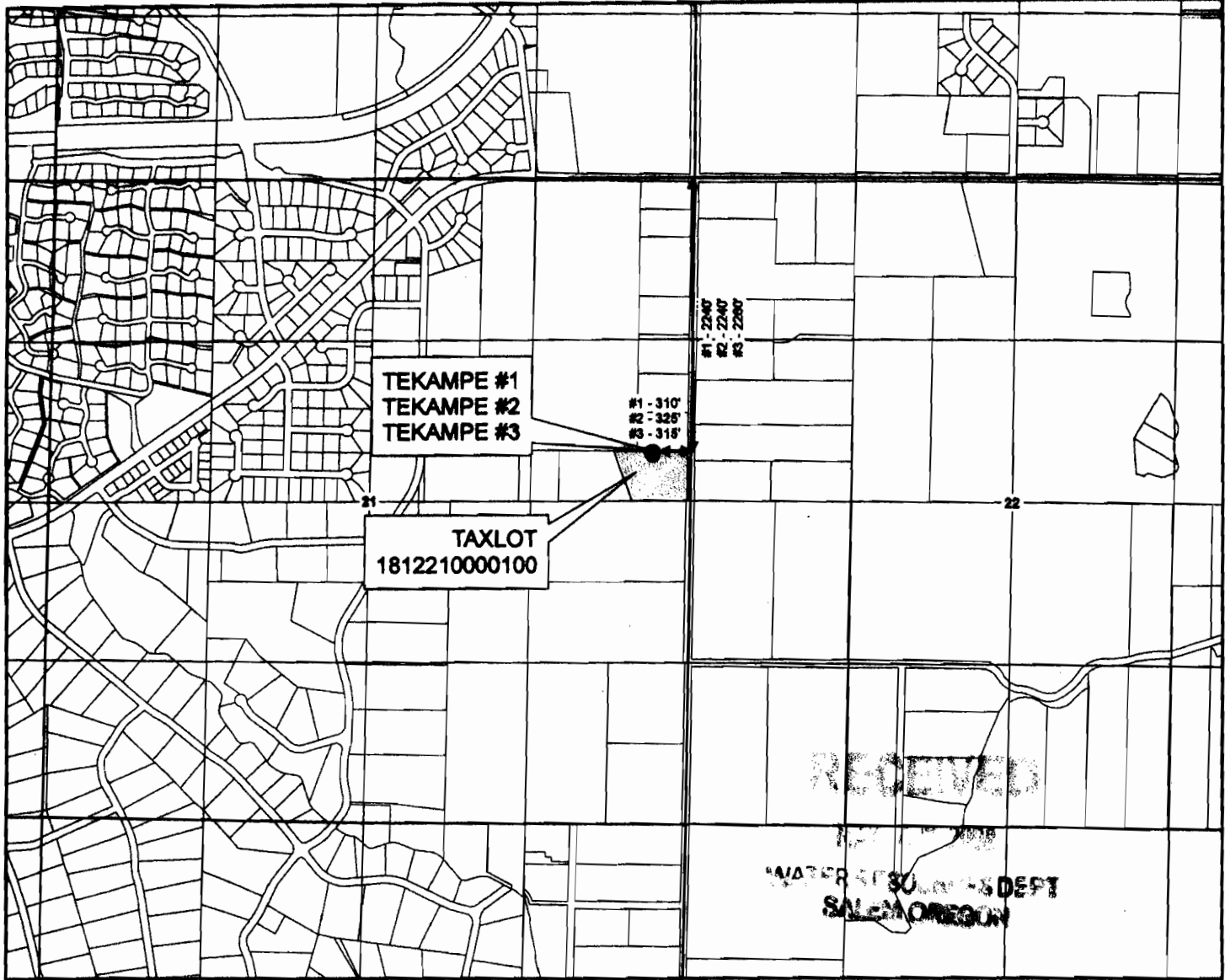

1 inch equals 1,320 feet

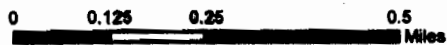

DRAWN BY: TANNER LEMMON
AVION WATER GIS DEPARTMENT
MARCH, 2008

DISCLAIMER:
This map was prepared for the purpose of identifying the location of water rights only and is not intended to provide legal dimensions or locations of property ownership lines.

Legend

- POINTS OF APPROPRIATION
- WELL SITE

WELL DESCRIPTION

TEKAMPE #1 (WELL C-1) -
SE 1/4, NE 1/4 of
Section 21, T 18 S, R 12 E,
WM - 2240' South and 310'
West from the NE corner of
Section 21
Taxlot - 1812210000100

TEKAMPE #3 (WELL C-2) -
SE 1/4, NE 1/4 of
Section 21, T 18 S, R 12 E,
WM - 2280' South and 315'
West from the NE corner of
Section 21
Taxlot - 1812210000100

TEKAMPE #2 (WELL C-3) -
SE 1/4, NE 1/4 of
Section 21, T 18 S, R 12 E,
WM - 2240' South and 325'
West from the NE corner of
Section 21
Taxlot - 1812210000100

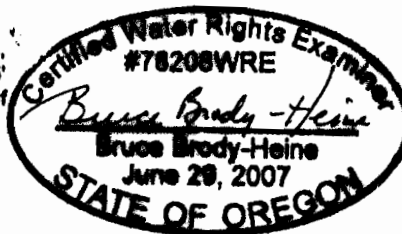

EXPIRES: 12/31/09

NOTES:

Measuring devices:
Refer to Attachment 6

Conveyance System:
Refer to the overview map in
Attachment 1

Base Layer:
Deschutes County Taxdot Shapefile
Projected Coordinate System :
NAD 1983 StatePlane Oregon South
Geographic Coordinate System :
GCS North American 1983



AVION WATER CO, INC.
CLAIM OF BENEFICIAL USE - WELL LOCATION MAP

Application G-18884, Permit G-12788
 Permit Amendments T-7778; T-10487
 Deschutes County

T18S R12E

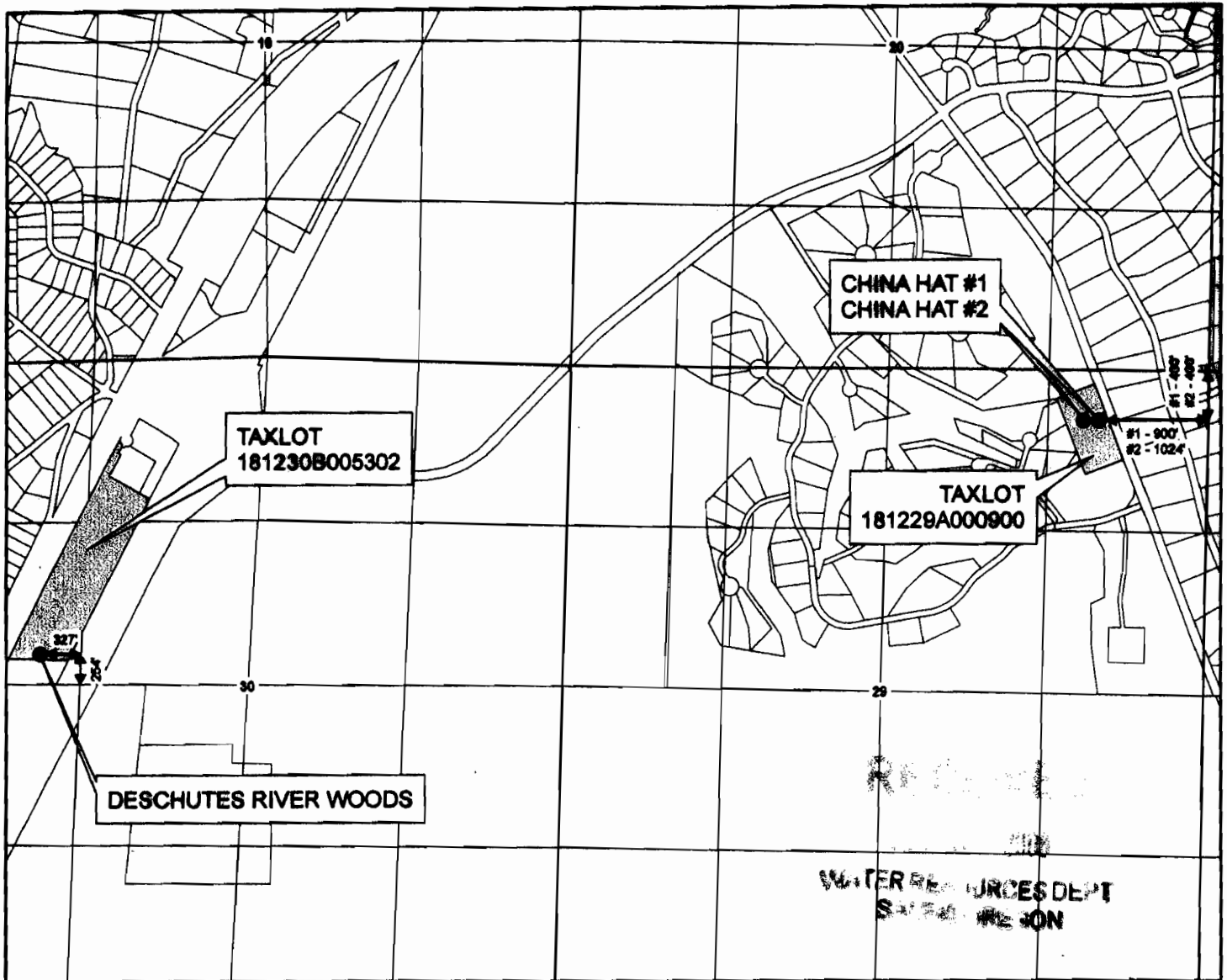

1 inch equals 1,320 feet



DRAWN BY: TANNER LEMMON
 AVION WATER CO'S DEPARTMENT
 MARCH, 2008

DISCLAIMER:
 This map was prepared for the purpose of identifying the location of water rights only and is not intended to provide legal dimensions or locations of property ownership lines.

Legend

- POINTS OF APPROPRIATION
- WELL SITES

WELL DESCRIPTION

DESCHUTES RIVER WOODS -
 SW 1/4, NW 1/4 of
 Section 30, T 18 S, R 12 E,
 WM - 254' North and 327'
 West from the SE corner of
 SW 1/4, NW 1/4, Section 30
 Taxlot - 181230B005302

CHINA HAT #2 -
 NE 1/4, NE 1/4 of
 Section 29, T 18 S, R 12 E,
 WM - 400' South and 1024'
 West from the NE corner of
 Section 29
 Taxlot - 181229A000900

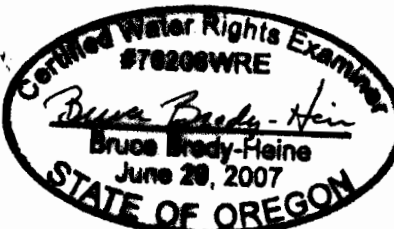

EXPIRES: 12/31/09

NOTES:

Measuring devices:
 Refer to Attachment 6

Conveyance System:
 Refer to the overview map in
 Attachment 1

Base Layer:
 Deschutes County Taxlot Shapefile
 Projected Coordinate System :
 NAD 1983 StatePlane Oregon South
 Geographic Coordinate System :
 GCS North American 1983

CHINA HAT WELL #1 -
 NE 1/4, NE 1/4 of
 Section 29, T 18 S, R 12 E,
 WM - 400' South and 900'
 West from the NE corner of
 Section 29
 Taxlot - 181229A000900



AVION WATER CO, INC.
CLAIM OF BENEFICIAL USE - WELL LOCATION MAP

Application G-18884, Permit G-12788
 Permit Amendments T-7776; T-18467
 Deschutes County

T18S R12E

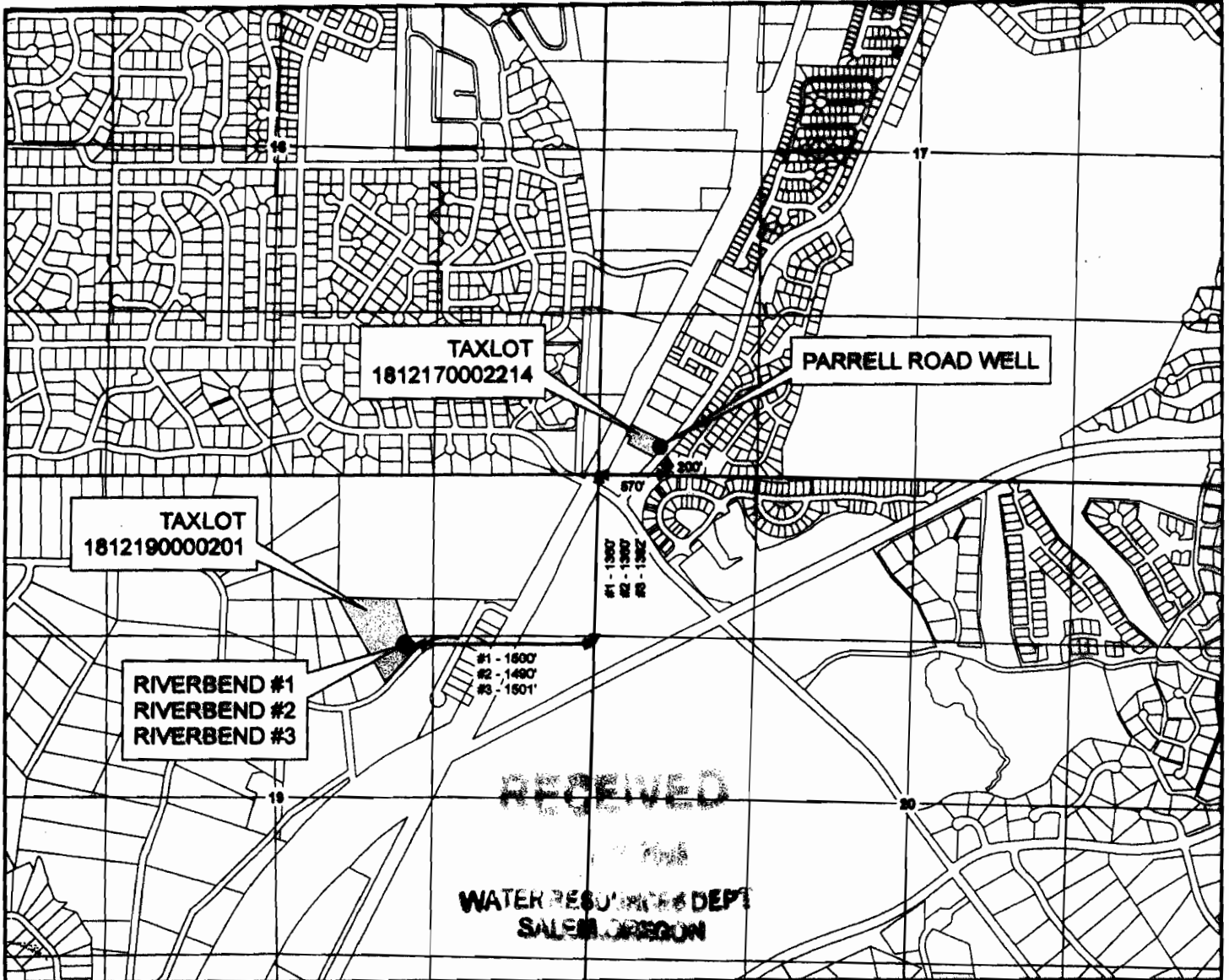

1 inch equals 1,320 feet



DRAWN BY: TANNER LEMMON
 AVION WATER GIS DEPARTMENT
 MARCH, 2008

DISCLAIMER:
 This map was prepared for the purpose of identifying the location of water rights only and is not intended to provide legal dimensions or locations of property ownership lines.

Legend

- POINTS OF APPROPRIATION
- WELL SITES

WELL DESCRIPTION

PARRELL ROAD WELL -
 SW 1/4, SW 1/4 of
 Section 17, T 18 S, R 12 E,
 WM - 200' North and 570'
 East from the SW corner of
 Section 17
 Taxlot - 1812170002214

RIVERBEND #2 (WELL B-2) -
 SW 1/4, NE 1/4 of
 Section 19, T 18 S, R 12 E,
 WM - 1380' South and 1480'
 West from the NE corner of
 Section 19
 Taxlot - 1812190000201

RIVERBEND #1 (WELL 5) -
 SW 1/4, NE 1/4 of
 Section 19, T 18 S, R 12 E,
 WM - 1380' South and 1800'
 West from the NE corner of
 Section 19
 Taxlot - 1812190000201

RIVERBEND #3 -
 SW 1/4, NE 1/4 of
 Section 19, T 18 S, R 12 E,
 WM - 1382' South and 1801'
 West from the NE corner of
 Section 19
 Taxlot - 1812190000201

NOTES:

Measuring devices:
 Refer to Attachment 6

Conveyance System:
 Refer to the overview map in
 Attachment 1

Base Layer:
 Deschutes County Taxlot Shapefile
 Projected Coordinate System :
 NAD 1983 StatePlane Oregon South
 Geographic Coordinate System :
 GCS North American 1983

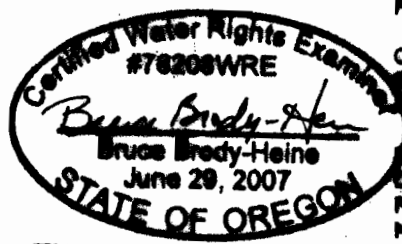

EXPIRES: 12/31/09



AVION WATER CO, INC.

CLAIM OF BENEFICIAL USE - WELL LOCATION MAP

1 of 6

Application G-12884, Permit G-12788
Permit Amendments T-7778; T-18487
Deschutes County

T17S R12E

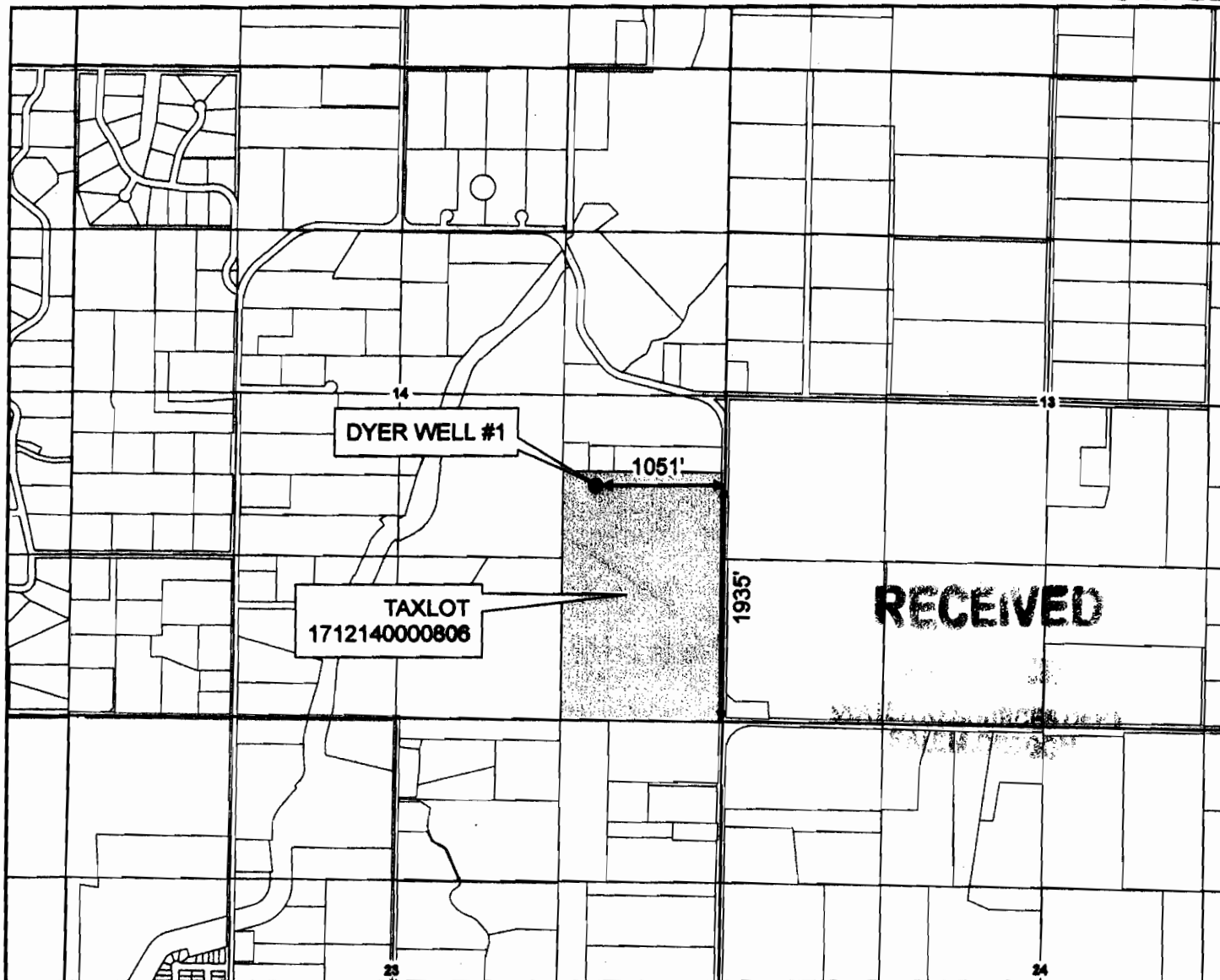

1 inch equals 1,320 feet



DRAWN BY: TANNER LEMMON
AVION WATER GIS DEPARTMENT
MARCH, 2008

DISCLAIMER:
This map was prepared for the purpose of identifying the location of water rights only and is not intended to provide legal dimensions or locations of property ownership lines.

Legend

- POINT OF APPROPRIATION
- WELL SITE

WELL DESCRIPTION

DYER WELL # 1 -
NE 1/4, SE 1/4 of
Section 14, T 17 S, R 12 E,
WM - 1935' North and 1051'
West from the SE corner of
Section 14
Taxlot - 1712140000808

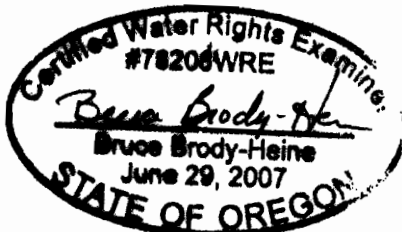

EXPIRES: 12/31/07

NOTES:

Measuring devices:
Refer to Attachment 6

Conveyance System:
Refer to the overview map in
Attachment 1

Base Layer:
Deschutes County Taxlot Shapefile
Projected Coordinate System :
NAD 1983 StatePlane Oregon South
Geographic Coordinate System :
GCS North American 1983