

RECEIVED

# FINAL PROOF T33S R1W W.M.

SEP 28 1999

WATER RESOURCES DEPT.  
SALEM, OREGON

APPLICATION NO. S-72282

PERMIT NO. 51721

SEPTEMBER 20, 1999

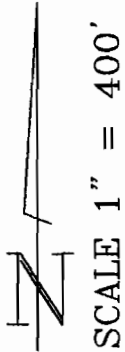

NW 1/4 of SE 1/4

NE 1/4 of SE 1/4

1/4  
CORNER  
35  
36

POINT OF  
DIVERSION

1564' SOUTH  
1467' WEST OF  
EAST 1/4 CORNER  
SECTION 35

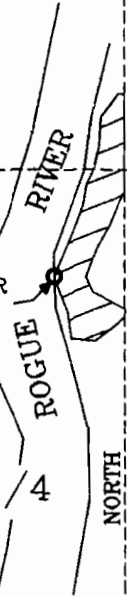

0.16 AC

1.0 AC

0.84 AC

NW 1/4 of SE 1/4  
SW

SE 1/4 of SE 1/4

*Amended by WRD Staff,  
7-30-08 JWS*

SURVEY FOR:

GARY AND REBECCA RHINEHART  
4041 FERRY ROAD  
SHADY COVE, OREGON 97539

BEARINGS BASED ON COMPASS READING  
19 1/2° EAST DECLINATION

DISTANCES SHOWN DERIVED FROM FILED  
SURVEY NO. 5277, JACKSON COUNTY, OR.

SURVEY BY:



KERRY K. BRADSHAW L.S. 2271  
P.O. BOX 3064  
CENTRAL POINT OREGON 97502  
(541)684-7610 CELL 944-6692

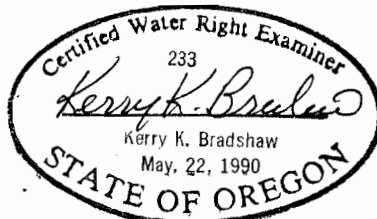

EAST  
1320'

35 36  
2 1