

T. 26 S., R. 6 W., W. M.

Sec. 23

Scale: 1" = 400'

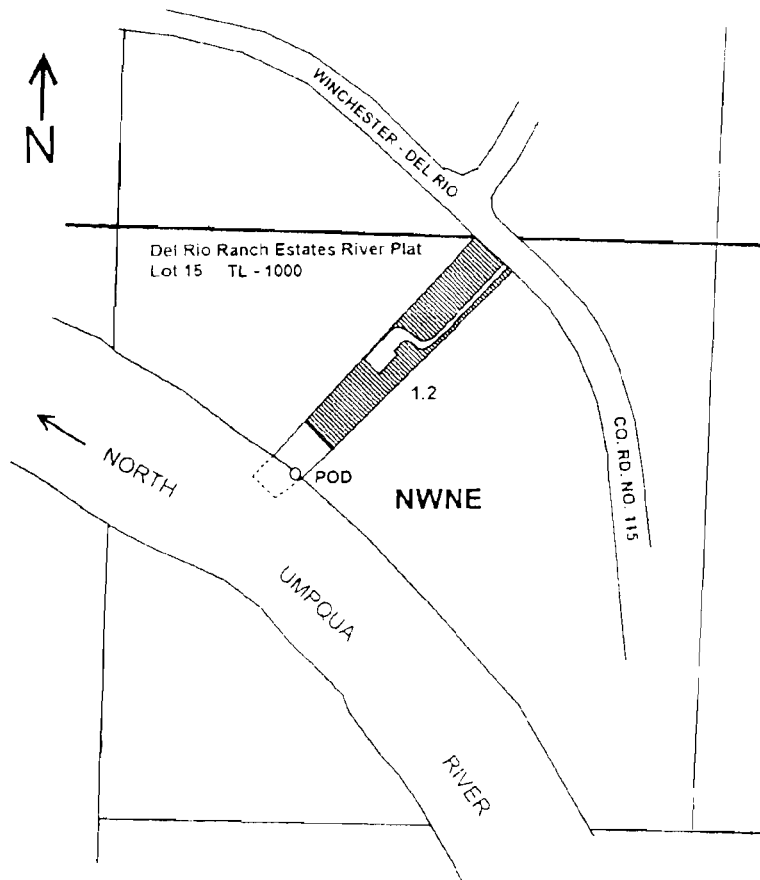

POD is located 535 ft. S. and 410 ft. E. from the N 1/4 corner of Sec. 23

**FINAL PROOF SURVEY**

UNDER

T-5895

Application No. S38746 Permit No. S28837

IN NAME OF

CRAIG E. and GINA L. TANNER

Surveyed June 20, 2008 by V. Church, D. Williams

**RECEIVED**

NOV 07 2008

WATER RESOURCES DEPT  
SALEM, OREGON