

# T.5S. R.3W. Sec. 4 & 9

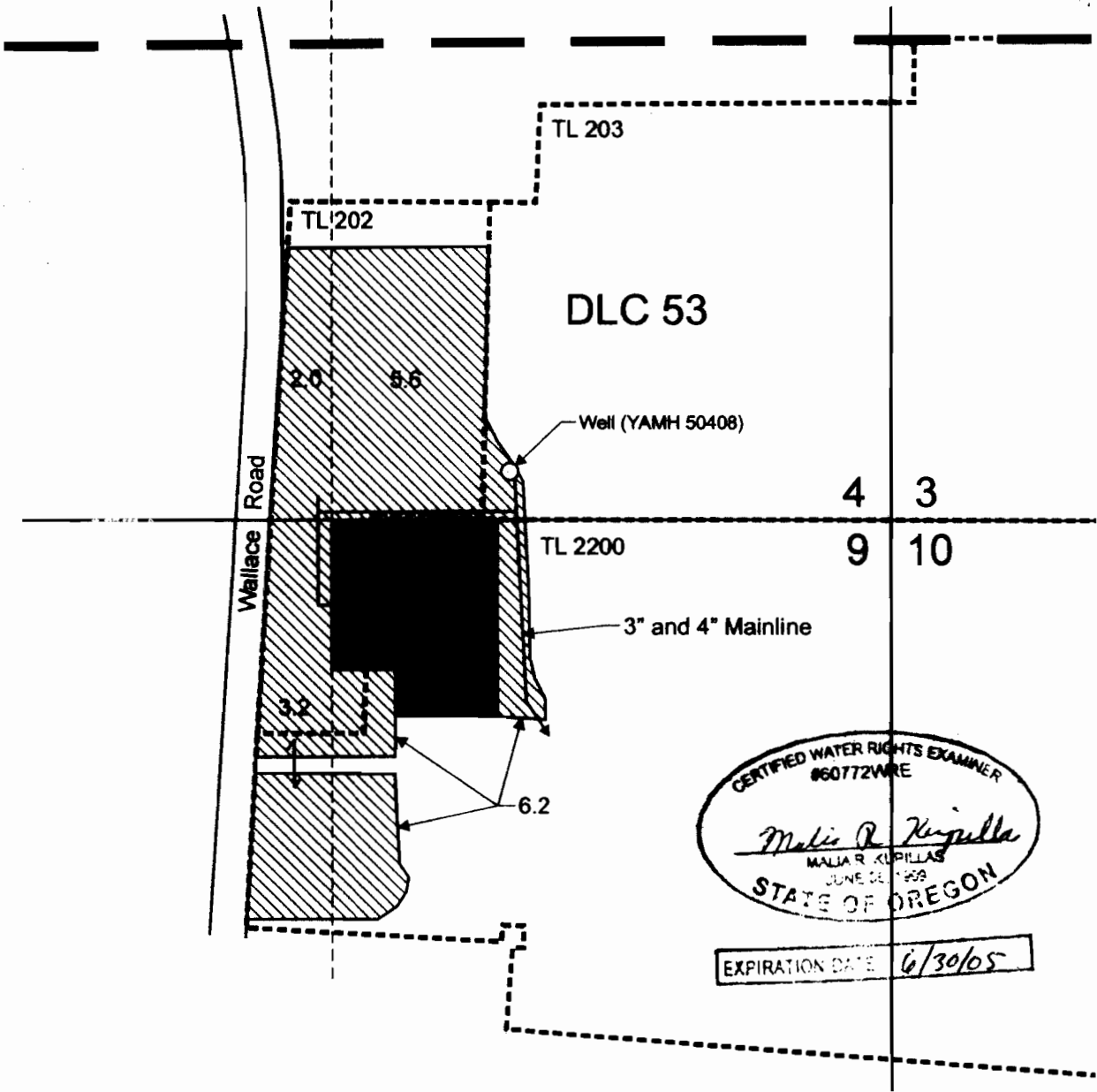

CERTIFIED WATER RIGHTS EXAMINER  
#60772WRE  
*Maria R. Kipillas*  
MARIA R. KIPILLAS  
JUNE 02, 1998  
STATE OF OREGON  
EXPIRATION DATE 6/30/05

Well (YAMH 50408) is located 115 feet north and 900 feet west from the SE corner of Section 4.

-  Area (17.0 Acres) irrigated under Application G-13994, Permit G-12654.
-  Tax lot boundary

Scale: 1" = 400'

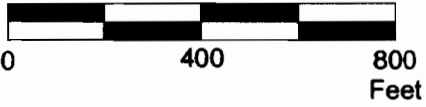

This map was prepared for the purpose of identifying the location of a water right only and is not intended to provide legal dimensions or location of property ownership lines.

## Claim of Beneficial Use Map

Carlton Plants  
T.5S. R.3W. Sec. 4, Tax Lots 202 and 203,  
and Sec. 9, Tax Lot 2200

Pacific Hydro-Geology Inc.

5/2004

CarltonMain.cdr