

RECEIVED

SEP 15 1999

WATER RESOURCES DEPT  
SALEM, OREGON

T.9 S. R.2 W., W.M.

W. MORRIS DLC 62



1" = 400'

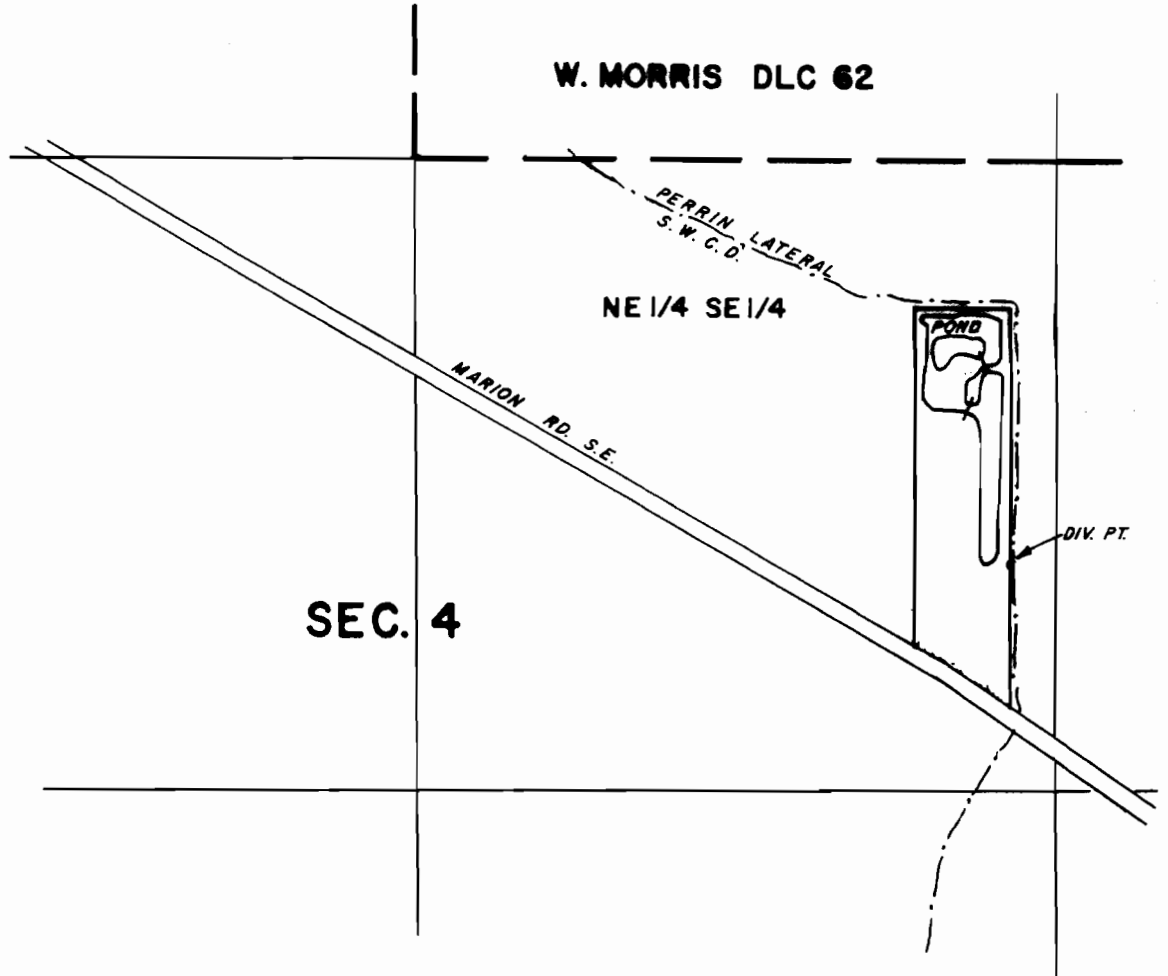

DIV. PT. LOC. 1250' E. & 850' S. FROM THE SW COR. OF W. MORRIS DLC 62

**FINAL PROOF SURVEY**  
UNDER

Application No. R-71634 Permit No. R-11602

IN NAME OF

**GENE COLLIER**

Surveyed Mar. 29 1991 by .....  
Inspected Aug. 13, 1999

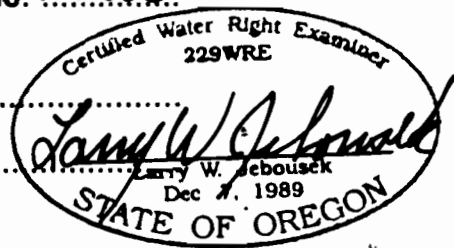

THIS MAP WAS PREPARED FOR THE PURPOSE OF IDENTIFYING THE LOCATION OF A WATER RIGHT ONLY AND IS NOT INTENDED TO PROVIDE LEGAL DIMENSIONS OR LOCATION OF PROPERTY OWNERSHIP LINES.