

T1N, R3E, W.M. SECTION 19

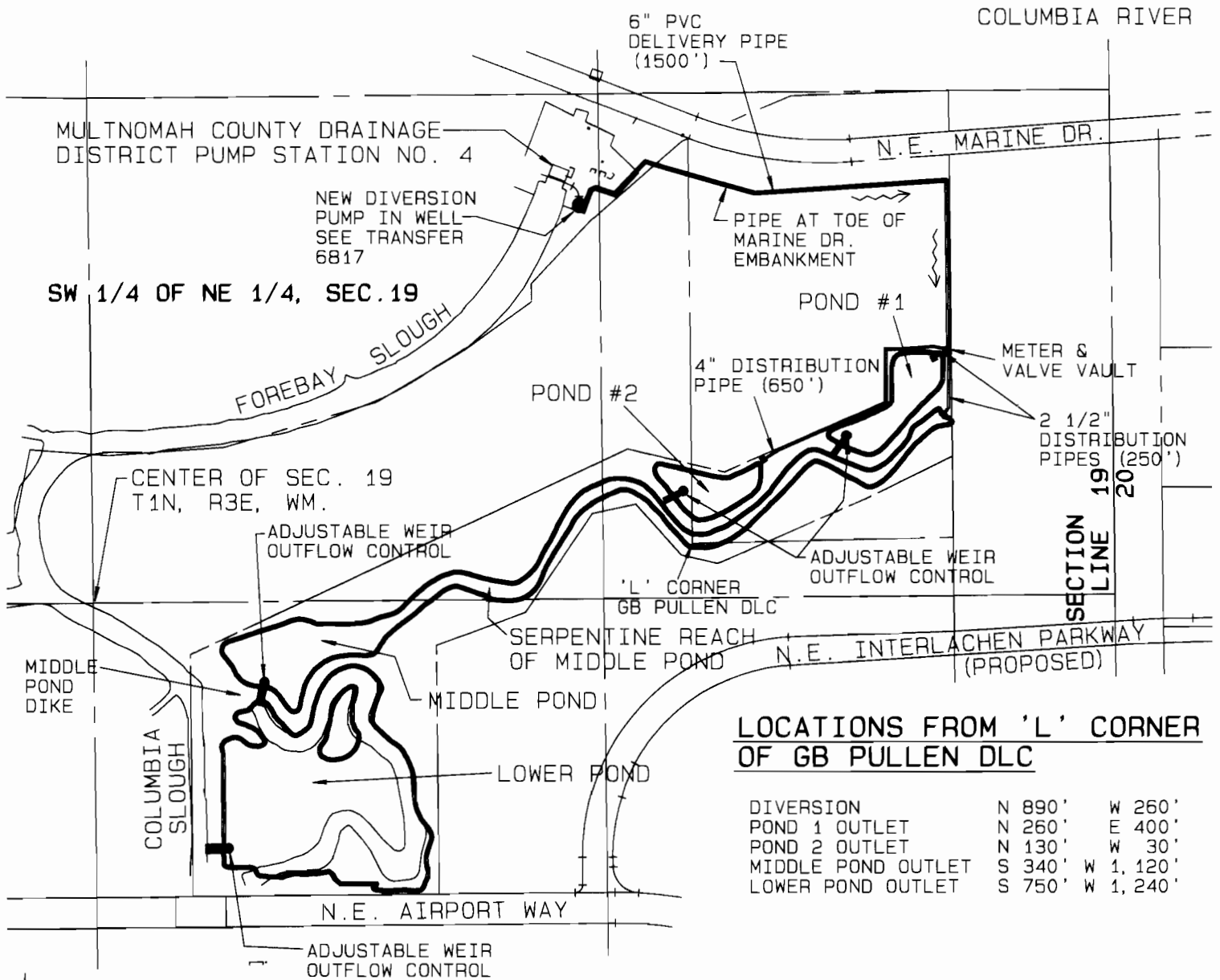

LOCATIONS FROM 'L' CORNER OF GB PULLEN DLC

DIVERSION	N 890'	W 260'
POND 1 OUTLET	N 260'	E 400'
POND 2 OUTLET	N 130'	W 30'
MIDDLE POND OUTLET	S 340'	W 1,120'
LOWER POND OUTLET	S 750'	W 1,240'

FINAL PROOF SURVEY

UNDER APPLICATION NO. R-72641 / PERMIT NO. R-11486

IN THE NAME OF:

DONALD COVILLE, CITY OF PORTLAND, AND
TIM HAYFORD, MULTNOMAH CO. DRAINAGE DISTRICT NO. 1
SURVEYED NOVEMBER 17, 1995

SCALE
1"=400'

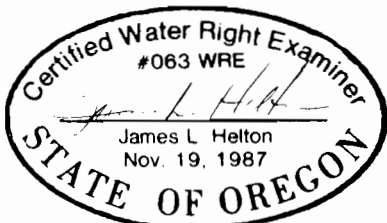

PREPARATION OF THIS MAP WAS FOR THE PURPOSE OF IDENTIFYING THE LOCATION OF THE RESERVOIRS ONLY AND HAS NO INTENT TO PROVIDE DIMENSIONS OR LOCATION OF PROPERTY OWNERSHIP LINES.