

T.6S., R.1W., W.M

RECEIVED
SEP 29 2000
WATER RESOURCES DEPT
SALEM, OR

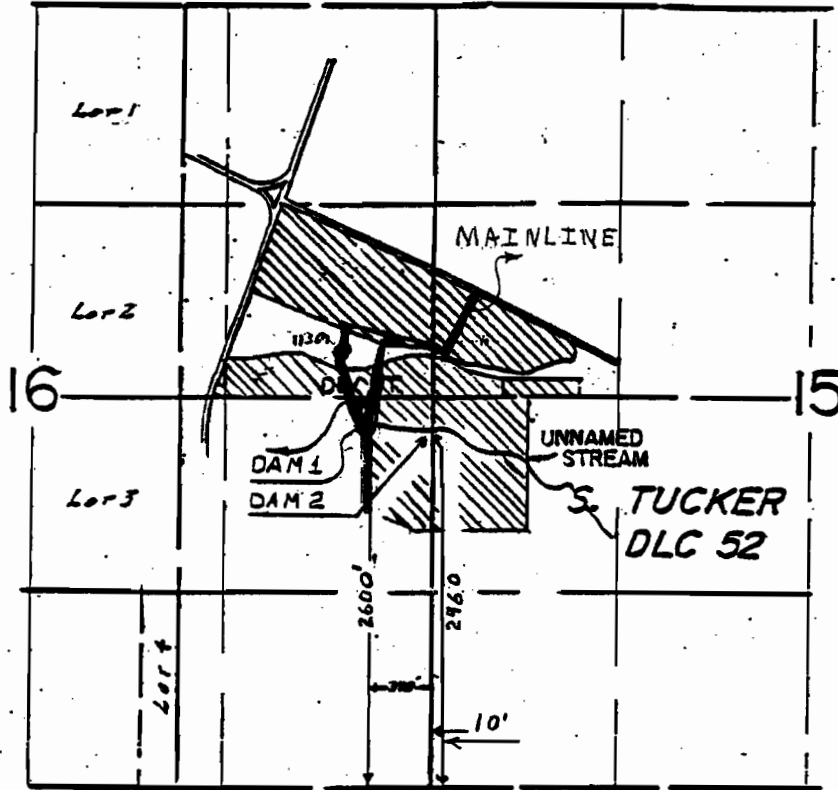

Diversion Point Location: NW 1/4 of the SW 1/4, Section 15 and NE 1/4 of the SE 1/4, Section 16, T.6S. R.1W.; Dam 1 is 2600 feet north and 390 feet west, Dam 2 is 2460 feet north and 10 feet east of the SW corner of Section 15.

Application R-75864 and S-75865
Permit R-11695 and S-52020



EXPIRATION DATE: 12/31/2000

 Area to be irrigated

Scale: 1" = 1,320'



0 1,320
Feet

This map was prepared for the purpose of identifying the location of a water right only and is not intended to provide legal dimensions or location of property ownership lines.



Claim of Beneficial Use

Ronald Buhr

T.6 S. R.1W. Sec. 15 and 16, TL 4198 and 4192

Pacific Hydro-Geology Inc.