

RECEIVED

JUN 12 1997

**WATER RESOURCES DEPT
SALEM, OREGON**

T.10S., R.3W., W.M.

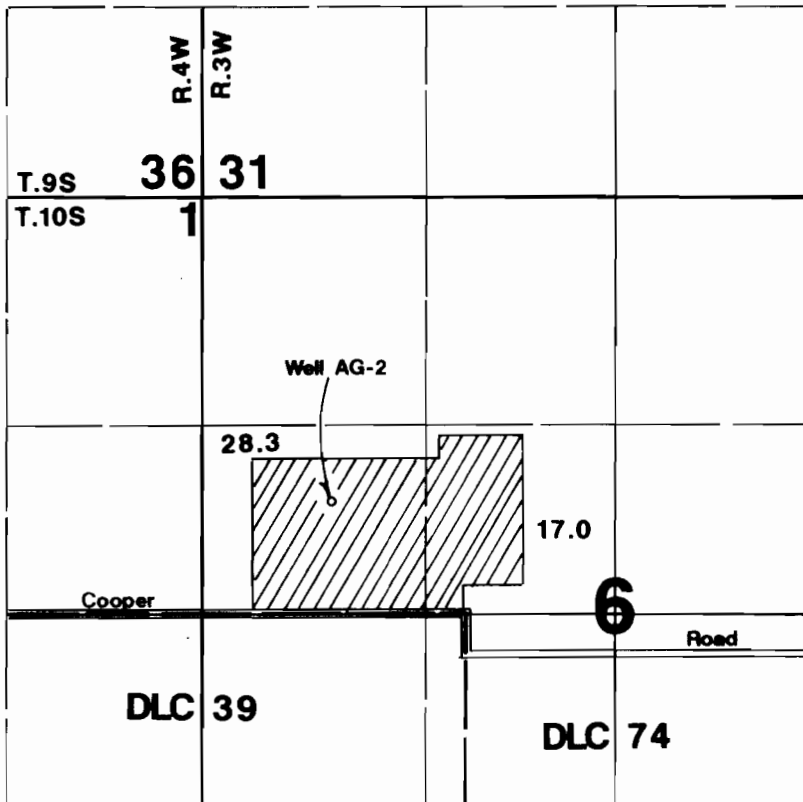

Well AG-2 located 800'N & 1950'W from center of Section 6.

Final Proof Survey

Application #: G-12932 Permit #: G-12048

In Name Of

Elmer Cook

Surveyed on June 2, 1997 by JM Schuette



THIS MAP WAS PREPARED FOR THE PURPOSE OF IDENTIFYING THE LOCATION OF A WATER RIGHT ONLY AND IS NOT INTENDED TO PROVIDE LEGAL DIMENSIONS OR LOCATION OF PROPERTY OWNERSHIP LINES.