

T3N, R29E, W1M.,
UMATILLA COUNTY, OREGON

FINAL PROOF SURVEY

FOR

Transfer No. 6095 and C-5998

APPLIC &
P 5215

RECEIVED
SEP 28 1992
WATER RESOURCES DEPT
SALEM, OREGON

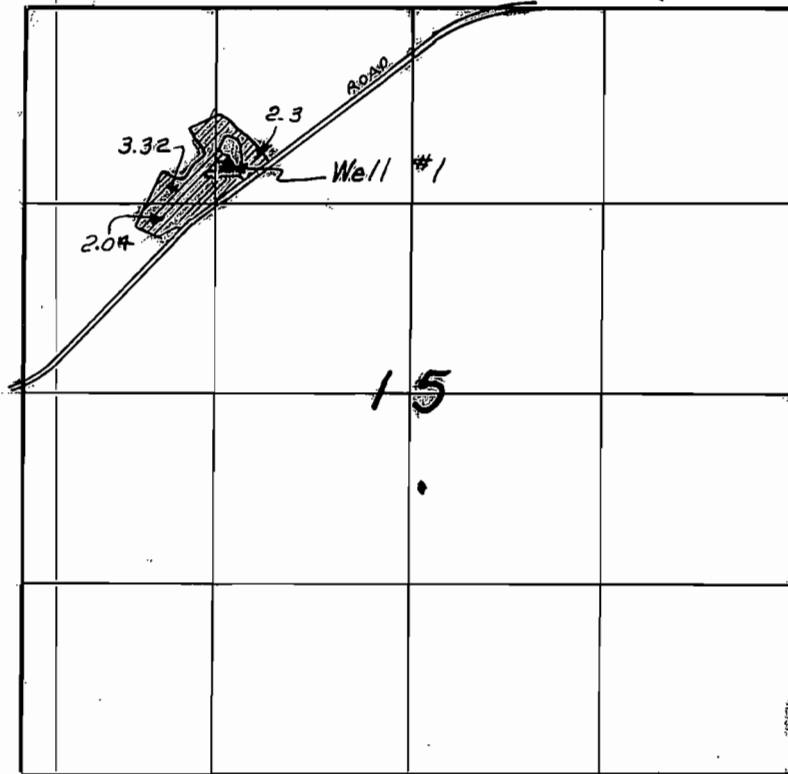

Scale: 1" = 1320'

Well #1 lies 1030 feet South and 1420 feet East of the N.W. corner of Section 15.

IN THE NAME OF
FRED WIDMAN
Rt. 2, Box 7
Echo, OR. 97826
Phone: 376-8421

This map is for identifying the location of water rights only and is not intended to show property lines or dimensions.

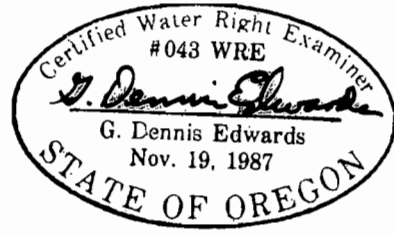

Edwards Surveying P.O. Box 763
567-3336 Hermiston, OR. 97838
9/23/92 Job # W8803012