

# APPLICATION MAP

## IN THE NAME OF PHILIP OLSON

### T 5 & 6 S, R 4 W, W.M. Section 33 & 4

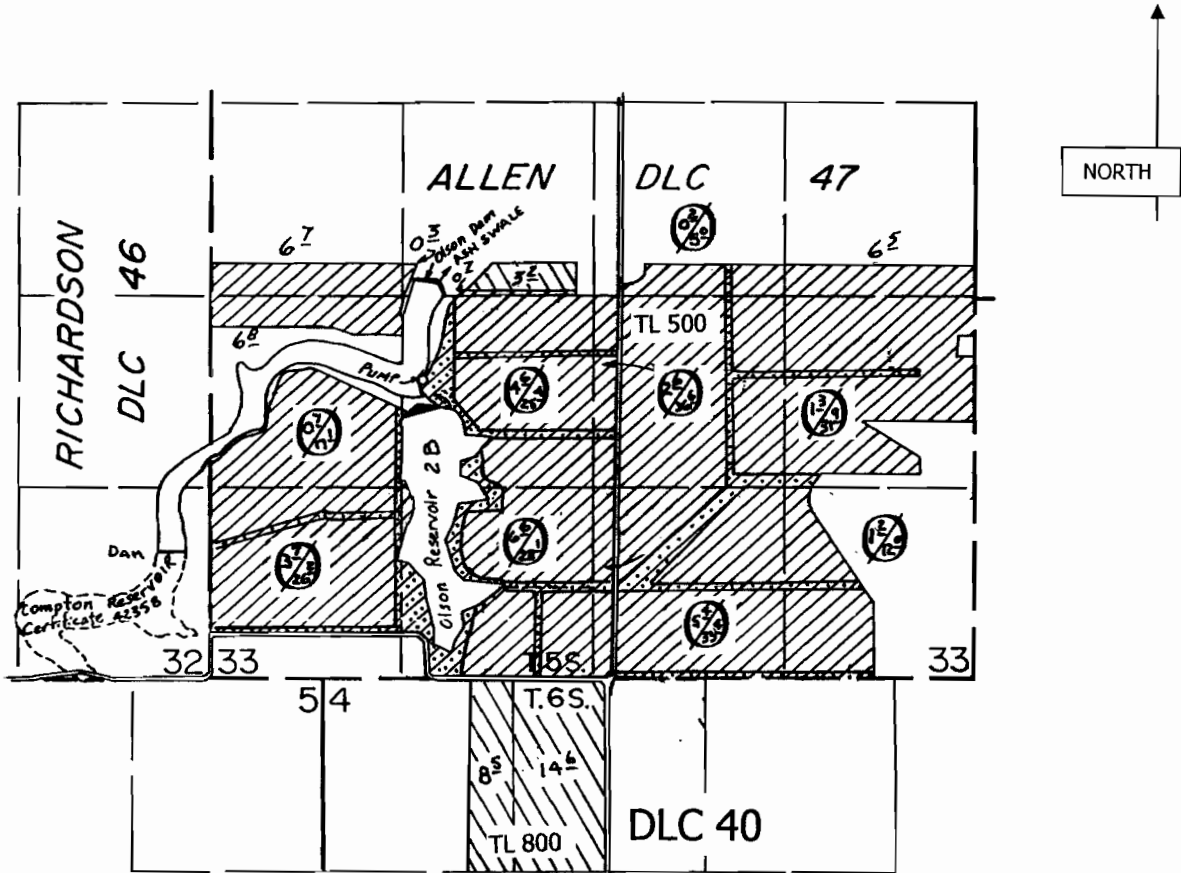

FROM  REMAINS  TO 

DIVERSION POINTS: 2720' N & 1570' E; 1860' N & 1450' E  
Both from the SW Corner section 33

**RECEIVED**

AUG 29 2007

Scale 1" = 1320'

WATER RESOURCES  
SALEM, OREGON

This map is not intended to provide legal dimensions or locations of property ownership lines.

T 10450

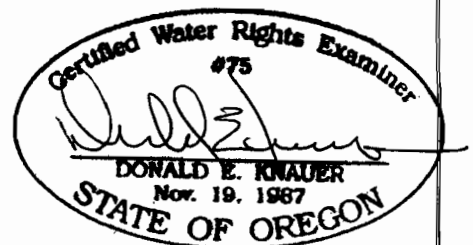

RENEWAL DATE: 6-20-2009