

# T. 36 S., R. 11 & 12 E., W.M.

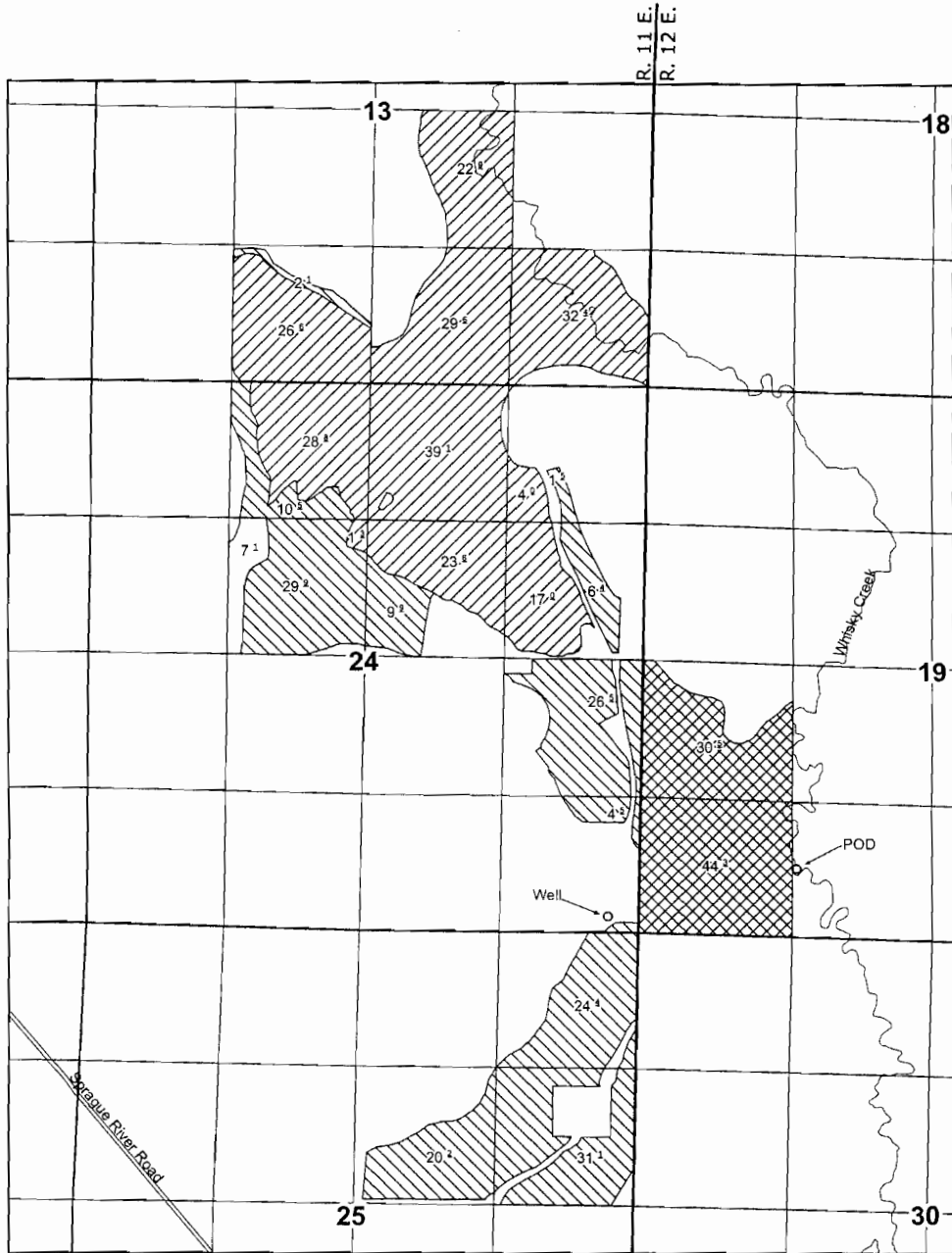

Well located 152' north & 294' west of SE cor. Sec. 24.  
 POD located 620' north & 1520' east of SW cor. Sec. 19.

## FINAL PROOF SURVEY





UNDER

58501                      44119  
 Application No. G-11380    Permit No. G-10498

IN THE NAME OF

**Bruce Topham**

Surveyed February 2008 by V. CHURCH

-  Primary P# 44119
-  Supplemental P# G-10498
-  Primary P# G-10498
-  Supplemental P# G-10498
-  Overacreage