

THIS MAP WAS PREPARED FOR THE PURPOSE OF IDENTIFYING THE LOCATION OF THE WATER RIGHT AND IS NOT INTENDED TO PROVIDE LEGAL DIMENSIONS OR LOCATIONS OF PROPERTY OWNERSHIP LINES.

T I I S ; R I Z E

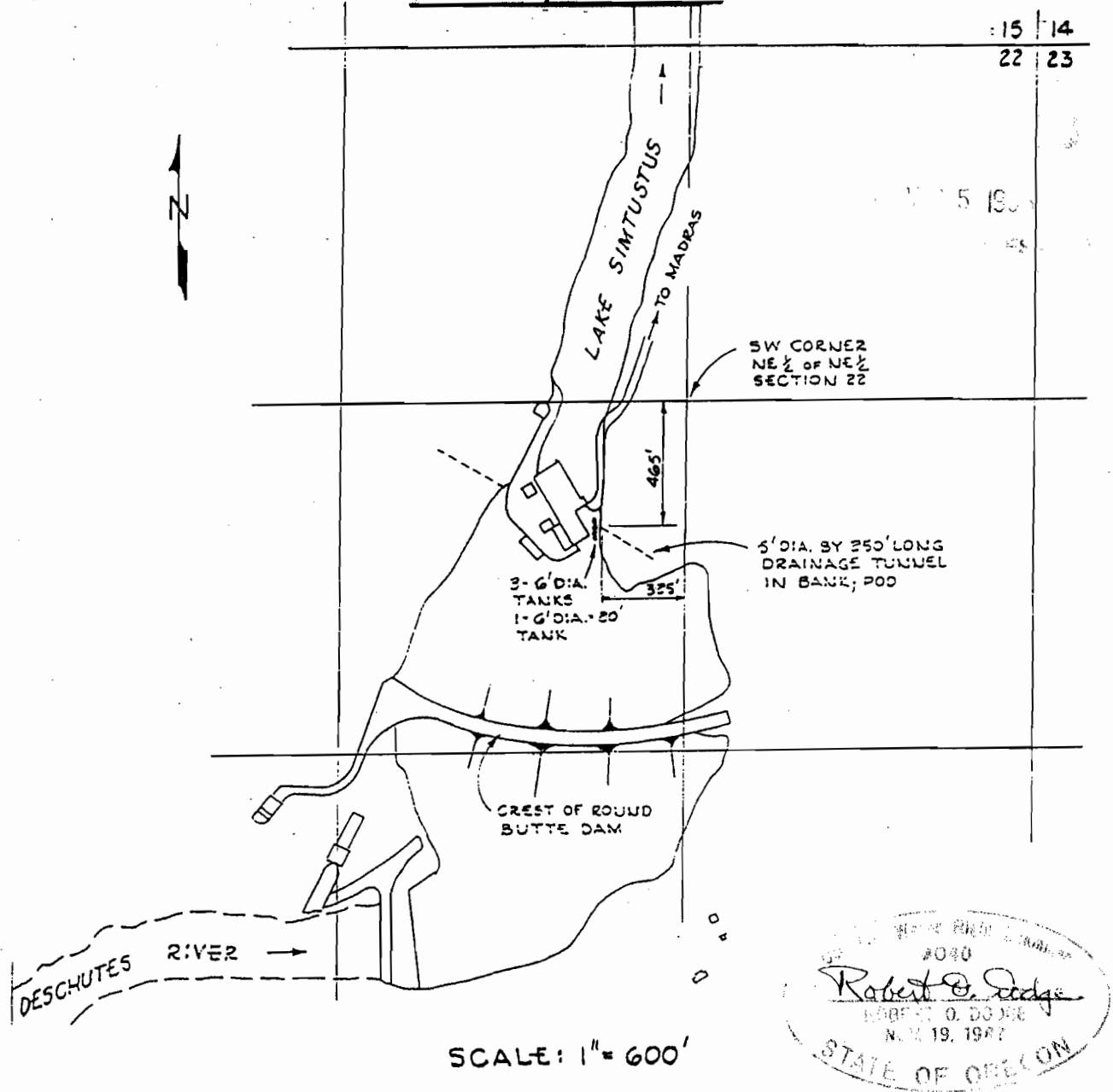

**FINAL PROOF SURVEY
UNDER**

APPLICATION NO. S-71345 PERMIT NO. 52642
IN NAME OF

OREGON DEPARTMENT OF FISH AND WILDLIFE

SURVEYED: 11/6/96 BY: DODGE