

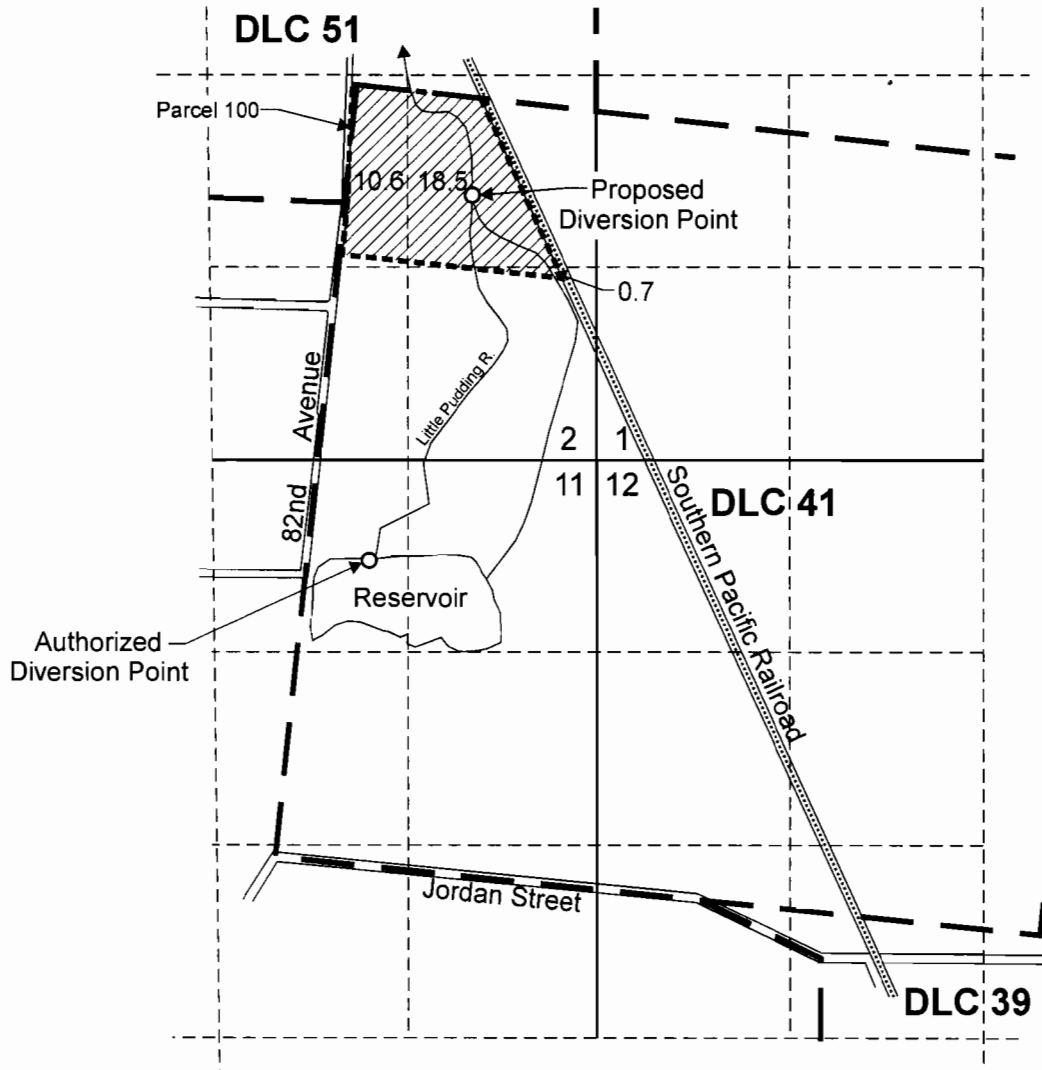

T.8S. R.2W. Sec. 2 & 11



Authorized diversion point is located 690 feet S. and 1,070 feet E. from the N 1/4 corner, Section 11.
 Proposed diversion point is located 760 feet S. and 790 feet E. from the NW corner, DLC 41.

 Area (29.8 Acres) under Permit S-31713, Certificate 82187 (Primary) affected by this transfer.

 Tax lot Boundary

RECEIVED

JUL 15 2008

WATER RESOURCES DEPT.
 SALEM, OREGON

Scale: 1" = 1,320'

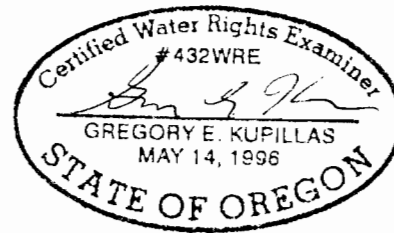

EXPIRATION DATE: 6/30/09

This map was prepared for the purpose of identifying the location of a water right only and is not intended to provide legal dimensions or location of property ownership lines.



Water Right Transfer Application Map

Roger and Mary Bakke
 Tax Lot 8 2W 02D 100

Pacific Hydro-Geology Inc.

7/2008

T 10674