

T. 5 S. R. 3 W., W. M.

RECEIVED

JUL 18 1996

WATER RESOURCES DEPT.
SALEM, OREGON



4" = 1 MI.

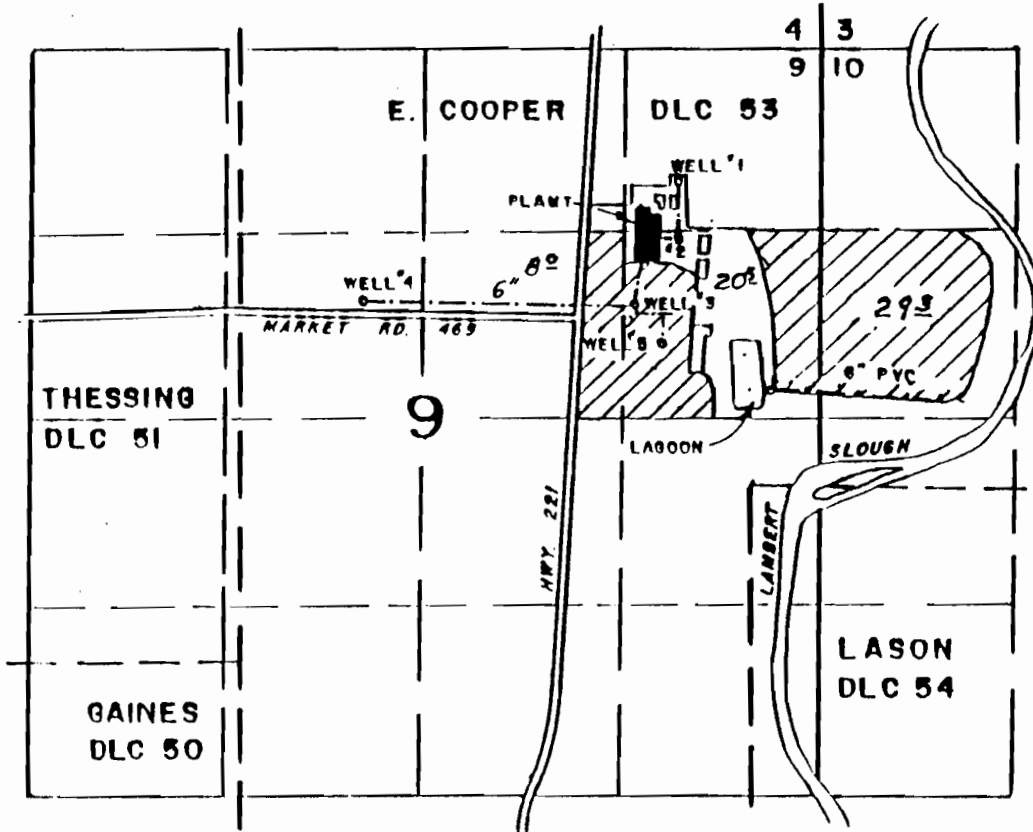

WELL LOC. FROM NE COR. SEC. 9:

- NO. 1 - 1310' @ S 45° 00' W
- NO. 2 - 940' W. & 1350' S.
- NO. 3 - 2140' @ S 70° 35' W
- NO. 4 - 3531' @ S 58° 45' W
- NO. 5 - 2060' S. & 980' W.

FINAL PROOF SURVEY FOR
TRANSFER NO. T-6500 AND
APPL. NO. G-12438 PER. NO. G-11502 BY

NORPAC FOODS, INC.

SURVEYED ON JUNE 12, 1996



THIS MAP WAS PREPARED FOR THE PURPOSE OF IDENTIFYING THE LOCATION OF A WATER RIGHT ONLY AND IS NOT INTENDED TO PROVIDE LEGAL DIMENSIONS OR LOCATION OF PROPERTY OWNERSHIP LINES.