

RECEIVED

FEB 19 1997

WATER RESOURCES DEPT.
SALEM, OREGON

T16S R2E W.M.

SW1/4 SE 1/4
SECTION 35

Note: This map is for the purpose of identifying the location of the water right only and is not intended to provide legal dimensions or location of property ownership lines.

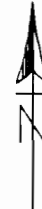

FOUND BRASS CAP
N 1/4 CORNER
SECTION 2

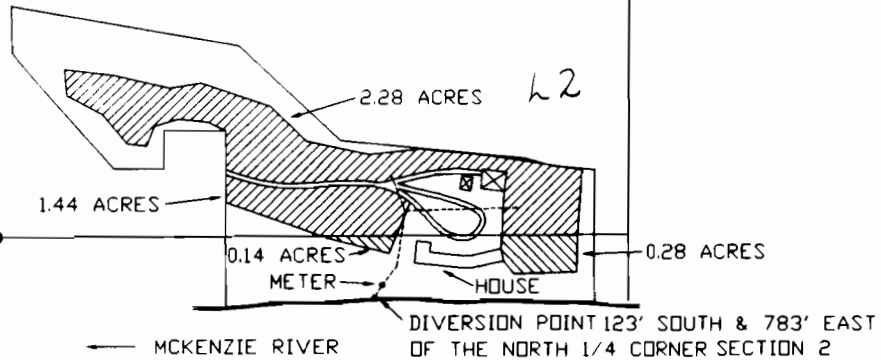

- OUT BUILDING
- BURIED 2" PVC WATERLINE
- AREA UNDER IRRIGATION

T17S R2E W.M.

NW1/4 NE1/4
SECTION 2

SCALE 1" = 400'



FINAL PROOF SURVEY

UNDER

APPLICATION NO. 71527

PERMIT NO. 51636

IN THE NAME OF

LEONARD & COLLEENE SWEDLOW

SURVEYED OCTOBER 5, 1996