

RECEIVED

SEP 9 1970

STATE ENGINEER
SALEM OREGON

RECEIVED

AUG 17 1970

STATE ENGINEER
SALEM, OREGON

RECEIVED

SEP 30 1970

STATE ENGINEER
SALEM, OREGON

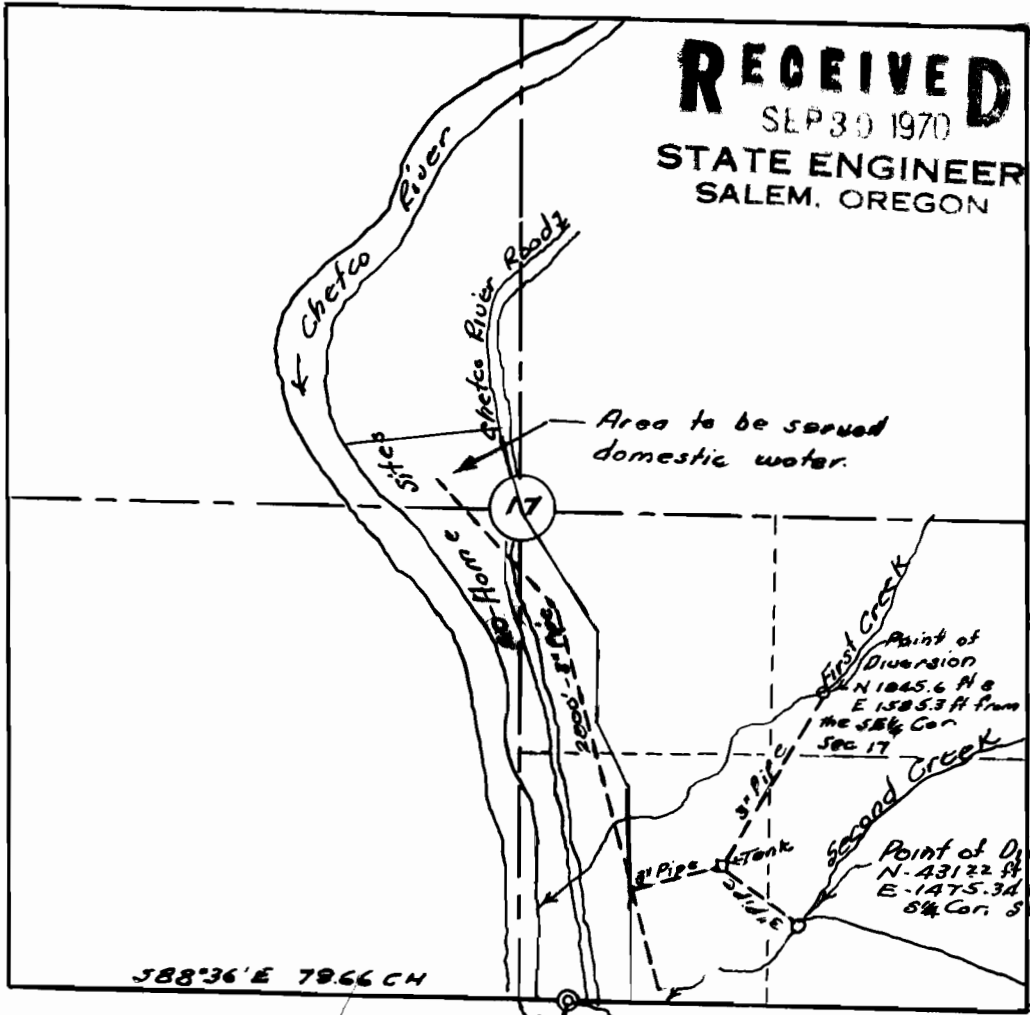

APPLICATION No. 47421 & 47422
Permit No. 35534 & 35535

MAP SHOWING
PROPOSED POINT OF DIVERSION & PIPE LINE
ARCHIE MCVAY & FRANK AKIN
SE 1/4 of SEC. 17, T 39S, R 12W Wm.
CURRY COUNTY - OREGON.