

TOWNSHIP 3 SOUTH, RANGE 2 WEST, W. M.

RECEIVED

JAN 21 1987

**WATER RESOURCES DEPT.
SALEM, OREGON**

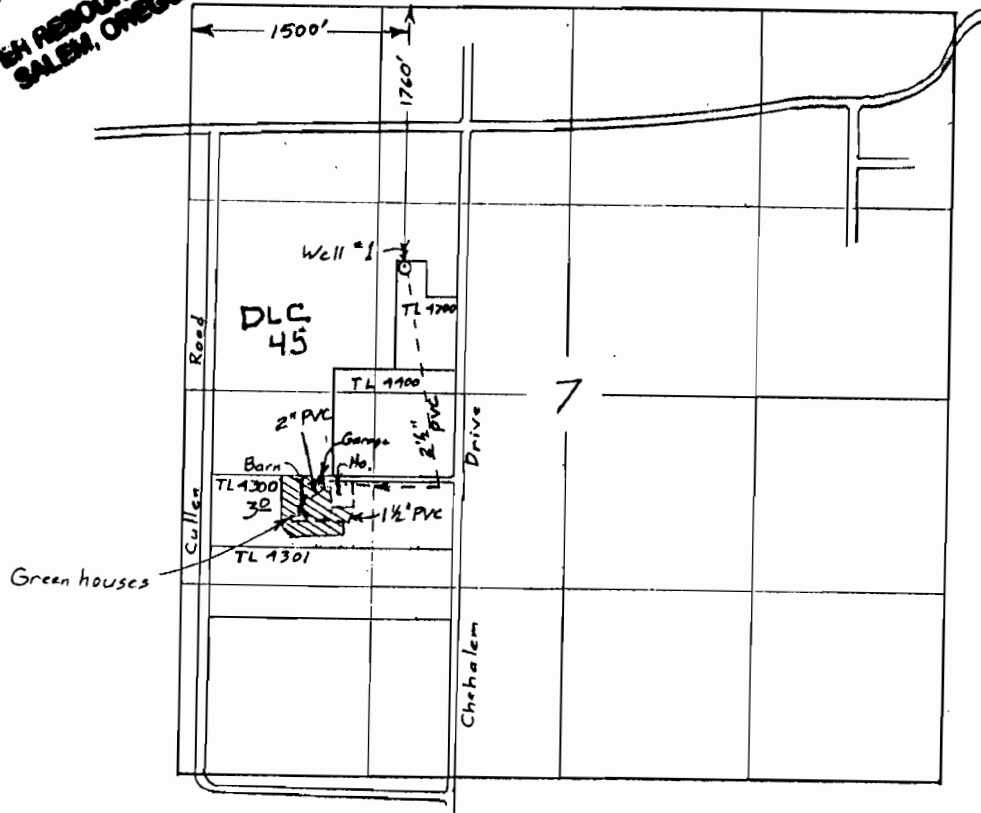

Scale 1" = 1320'

Surveyed Dec. 5, 1996

⊗ Nursery & Greenhouses

Claim of Beneficial Use Map
for
WILLIAM ROTH

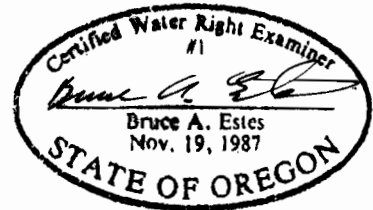

Application G-13678
Permit G-11949

MAP AMENDED BY WRD staff
11/3/08 twg

This map is for the purpose of locating a water right only and has no intent to provide legal dimensions or the location of property lines.

ESTES SURVEYS
 6293 Sunnyview Rd. NE Salem, OR 97305 (503) 585-7593
 60382 Arnold Rd. Bend, OR 97702 (503) 382-7391