

RECEIVED

T.34S.,R.1W.,W.M.

JUL - 1 1997

WATER RESOURCES DEPT.
SALEM, OREGON

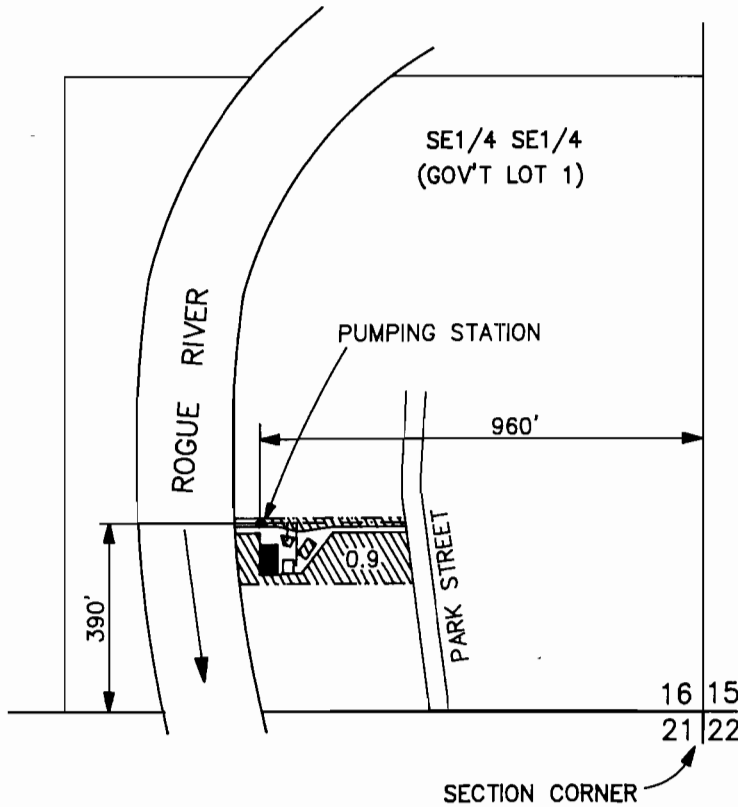

SCALE 1" = 400'

NOTE: MAP PREPARED FOR
WATER RIGHT PURPOSES ONLY,
NOT FOR PROPERTY BOUNDARY
LOCATIONS.

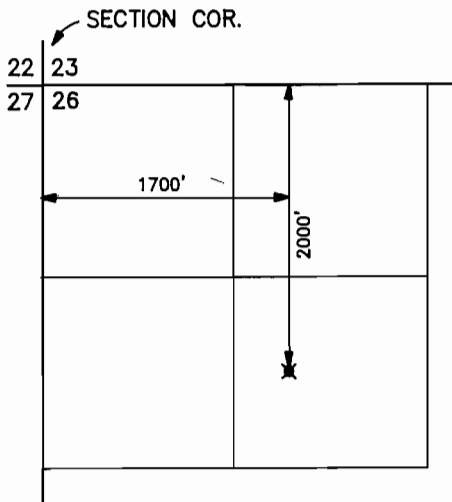
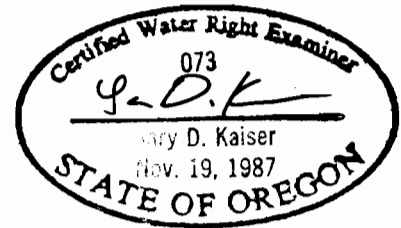

LOST CREEK RESERVIOR
POINT OF DIVERSION
T.33S.,R.1E.,W.M.
SCALE 1" = 1320'

FINAL PROOF MAP

APPLICATION No. S-77480
PERMIT No. 52783

IN THE NAME OF
HERBERT PLUMHOFF

MAP PREPARED JUNE 18, 1997 BY GARY D. KAISER