

**Map for
Claim of Beneficial Use
City of Eagle Point
T-10160
T 35 & 36 S, R 1 W**

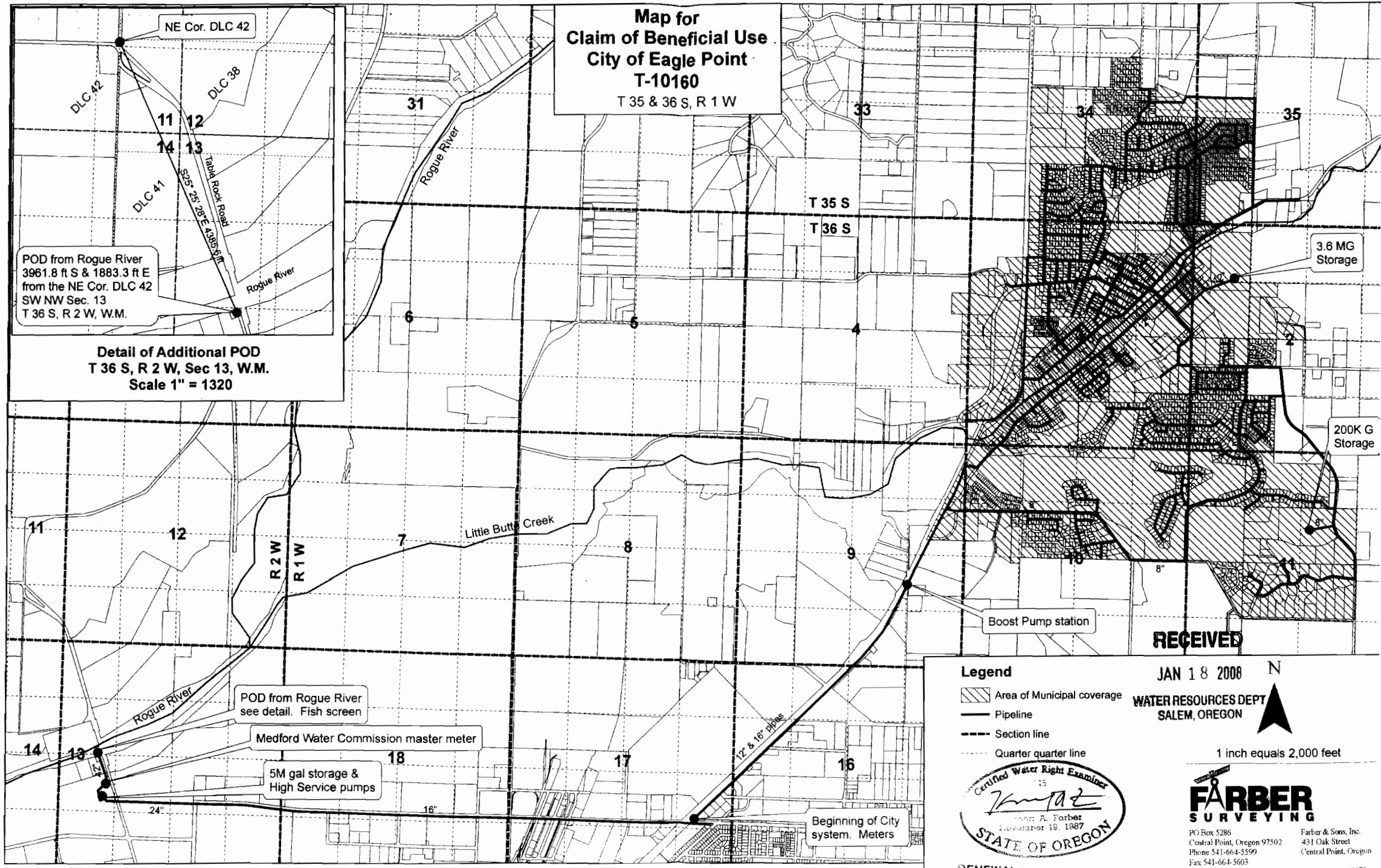

**Detail of Additional POD
T 36 S, R 2 W, Sec 13, W.M.
Scale 1" = 1320**

POD from Rogue River
3961.8 ft S & 1883.3 ft E
from the NE Cor. DLC 42
SW NW Sec. 13
T 36 S, R 2 W, W.M.

NE Cor. DLC 42
DLC 42
DLC 38
DLC 41
S55°25'28"E x 4385.61 ft
Rogue River
Rogue River

POD from Rogue River
see detail. Fish screen

Medford Water Commission master meter

5M gal storage &
High Service pumps

Beginning of City
system. Meters

17 & 16' slope

Little Butte Creek

Rogue River

R 2 W
R 1 W

Legend

- Area of Municipal coverage
- Pipeline
- Section line
- Quarter quarter line

RECEIVED
JAN 18 2008
WATER RESOURCES DEPT
SALEM, OREGON

1 inch equals 2,000 feet

FARBER SURVEYING
Certified Water Right Examiner
15
A. Farbat
November 19, 1887
STATE OF OREGON

PO Box 5286
Central Point, Oregon 97502
Phone 541-664-5359
Fax 541-664-5603
Email hafarbat@charter.net

Farber & Sons, Inc.
431 Oak Street
Central Point, Oregon
Tax ID: 93-1057173

RENEWAL DATE 12-31-07