

LEGEND:
 URBAN GROWTH BOUNDARY
 ROAD CENTERLINE
 DESCHUTES RIVER
 AUTHORIZED PLACE OF USE

Certified Water Right Examiner
 445WRE
 Terry Ann. Sprecher
 06/13/97
 STATE OF OREGON

0 1,320 2,640 5,280 7,920 10,560
 SCALE: 1"=5,280'

DISCLAIMER: The purpose of the map is to identify the location of the water right. It is not intended to provide information relative to the location of property ownership lines.

	Project #:	LF02 008	PLACE OF USE MAP	FIGURE
	Date:	03/11/2008	CITY OF BEND	1

CLAIM OF BENEFICIAL USE POINT OF APPROPRIATION MAP

APPLICATION #G-5644
PERMIT #G-4946
TRANSFER T-7009 AND T-9408

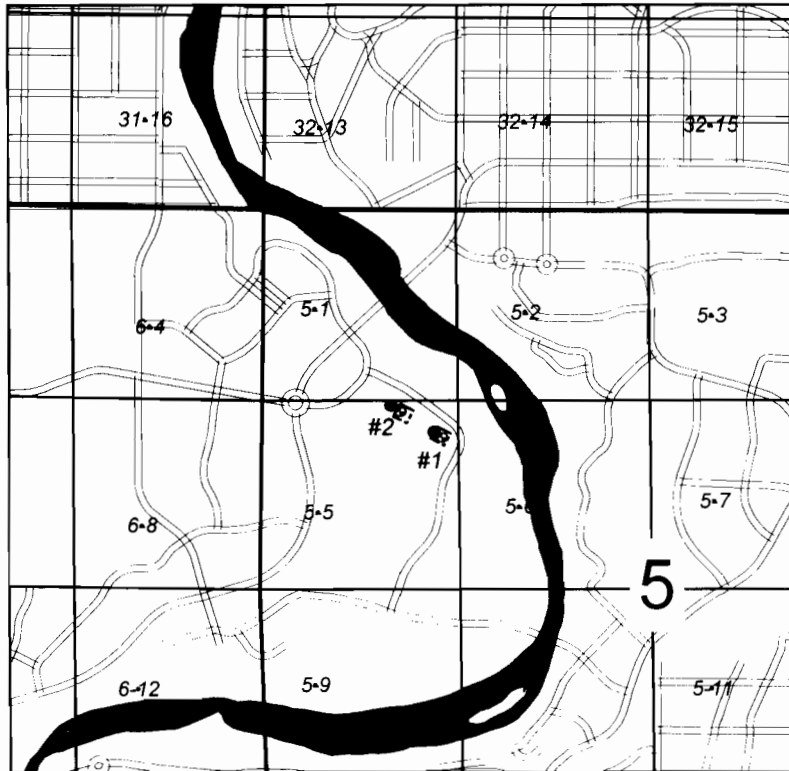

LEGEND:

- Well
- Flow Meters
- Well Taxlots
- Road_Centerline
- █ DESCHUTES RIVER

RIVER WELLS #1,2
TOWNSHIP 18S, RANGE 12E, WM
SECTION 5,
RIVER WELL #1 - TAX MAP 181205B, TAXLOT 1100
RIVER WELL #2 - TAX MAP 181205B, TAXLOT 900

AUTHORIZED PLACE OF USE IS WITHIN THE SERVICE AREA OF THE CITY OF BEND, SHOWN IN FIGURE 1.

RIVER WELLS:

WELL #1: S58°04'01"E, 3007.14 FEET FROM THE NW CORNER OF THE NE 1/4 OF THE NE 1/4 OF SECTION 6, T18S, R12E W.M.
WELL #2: 950 FEET EAST AND 1420 FEET SOUTH OF THE NW CORNER OF SECTION 5, T18S R12E W.M.

RECEIVED

APR 10 2008

**WATER RESOURCES DEPT
SALEM OREGON**

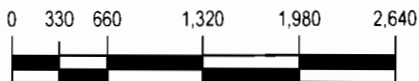
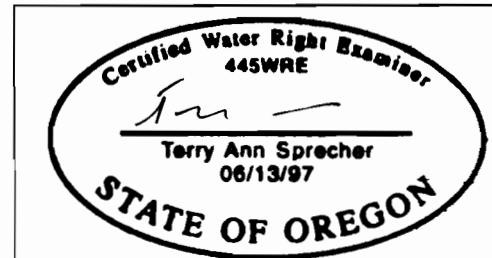

SCALE: 1"=1,320'

DISCLAIMER: The purpose of the map is to identify the location of the water right. It is not intended to provide information relative to the location of property ownership lines.

	Project #:	RIVER WELL FIELD CITY OF BEND	FIGURE
	Date: 03/11/2008		2

CLAIM OF BENEFICIAL USE POINT OF APPROPRIATION MAP

APPLICATION #G-5644
PERMIT #G-4946
TRANSFER T-7009 AND T-9408

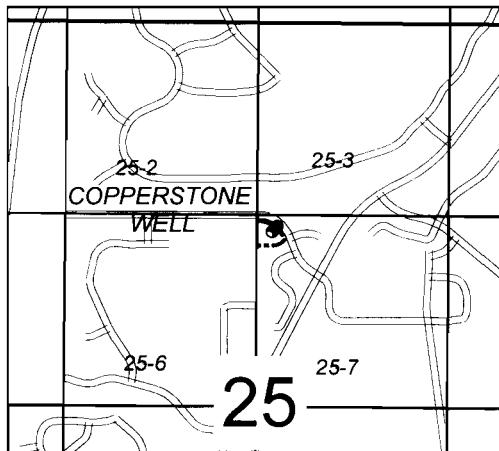

COPPERSTONE WELL
TOWNSHIP 17S, RANGE 11E, WM
SECTION 25,
TAX MAP 171125AC, TAXLOT 1300

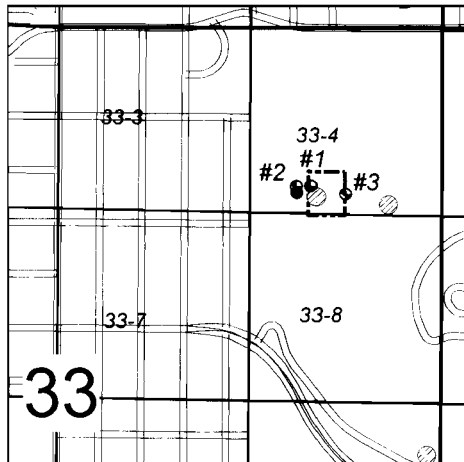

PILOT BUTTE WELL #1
TOWNSHIP 17S, RANGE 12E, WM
SECTION 33,
TAX MAP 171233A, TAXLOT 102

AUTHORIZED PLACE OF USE IS WITHIN THE SERVICE AREA OF THE CITY OF BEND, SHOWN IN FIGURE 1.

COPPERSTONE:
WELL #1: N5°55'14"E, 1209.8 FEET FROM THE SW CORNER OF NE 1/4 OF S25, T17S, R11E

PILOT BUTTE:
WELL #1: 200 FEET NORTH AND 400 FEET EAST OF THE SW CORNER OF THE NE 1/4 OF THE NE 1/4 OF SECTION 33, T17S R12E W.M.

BEAR CREEK:
WELL #1: N40°59'46"W, 1074.4 FEET FROM THE SE CORNER OF SECTION 33, T17S, R12E W.M.
WELL #2: N33°00'23"W, 1087.9' FEET FROM THE SE CORNER OF SECTION 33, T17S, R12E W.M.

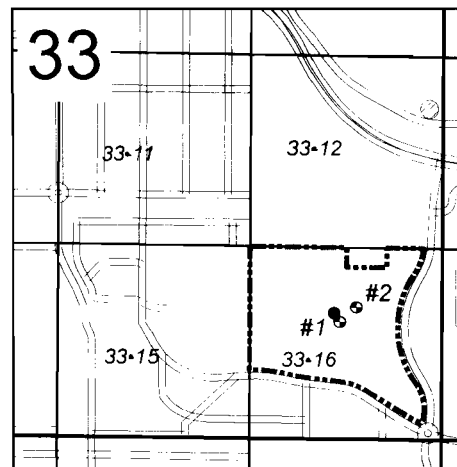

BEAR CREEK WELLS #1, #2
TOWNSHIP 17S, RANGE 12E, WM
SECTION 33,
TAX MAP 171233DD, TAXLOT 100

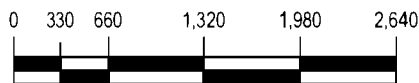

SCALE: 1"=1,320'

DISCLAIMER: The purpose of the map is to identify the location of the water right. It is not intended to provide information relative to the location of property ownership lines.

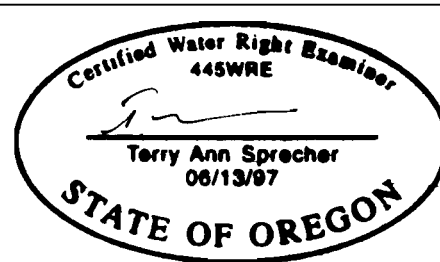

Project #:

Date:

03/11/2008

**COPPERSTONE WELL, PILOT BUTTE AND
BEAR CREEK WELL FIELDS**
CITY OF BEND

FIGURE

3