

Township 23 South Range 12 West, Willamette Meridian

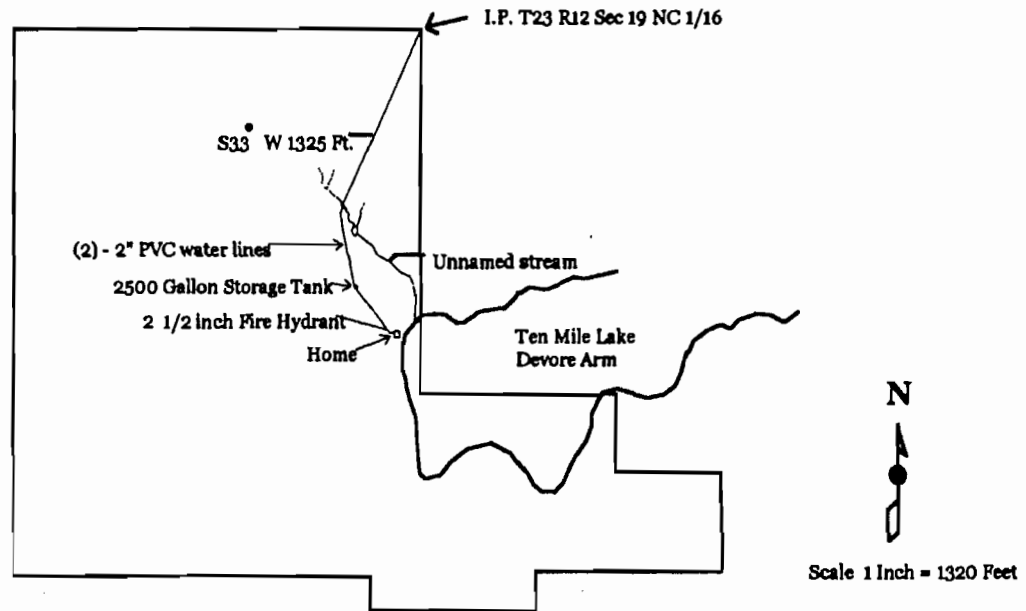

Diversion Point located 1325 ft., S 33° W
from the CN 1/16 corner Section 19

FINAL PROOF SURVEY

under

Appl. No. S-81058, Per. No. 53052

July 8, 1998

THIS MAP WAS PREPARED FOR THE PURPOSE OF IDENTIFYING THE LOCATION OF A WATER RIGHT ONLY AND IS NOT INTENDED TO PROVIDE LEGAL DIMENSIONS OR LOCATION OF PROPERTY OWNERSHIP LINES.

