

# T.3S., R.8W., W.M.

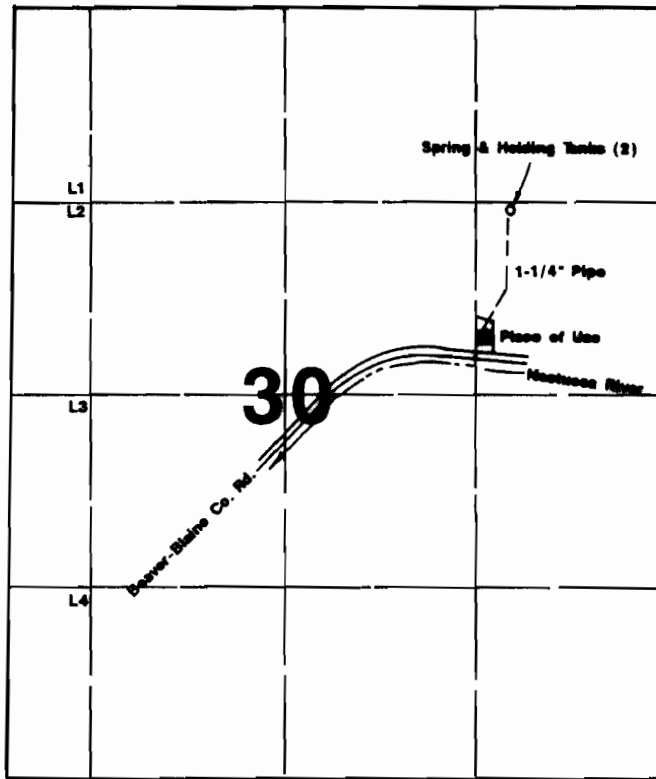

Diversion Point is located 30'S & 1027'W from the E 1/16 corner of the NE 1/4 of Section 30.

## Final Proof Survey

In Name Of

# Linton Whittles

Application #: S-74883

Permit #: 52735

Surveyed on September 24, 2000 by JM Schuette

This Map Was Prepared For The Purpose Of Identifying The Location Of A Water Right Only And Is Not Intended to Provide Legal Dimensions Or Location Of Property Ownership Lines.

