

# T2S. R2 & 3E. WM.

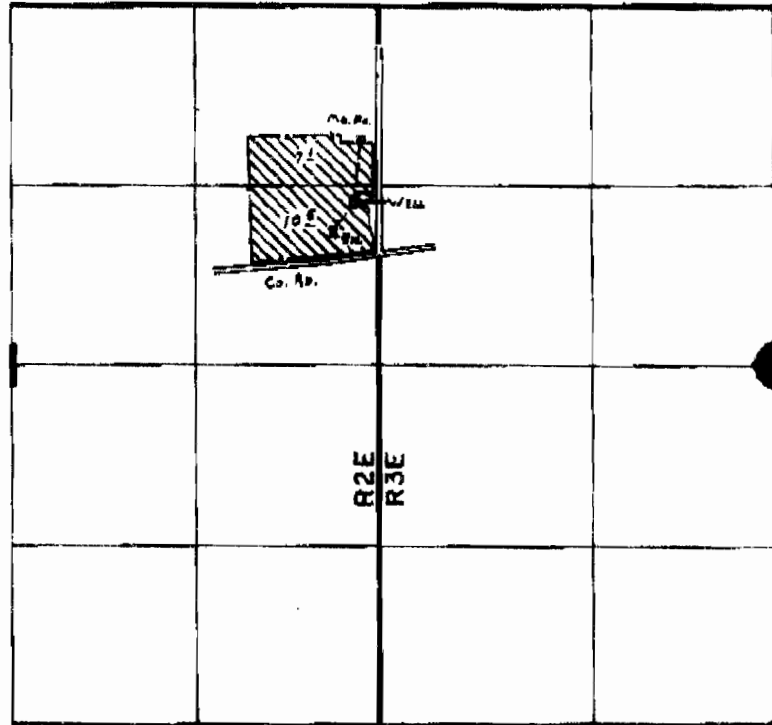

Well Loc: 1490'S. (170'W. fr. N.E. Co. Sec. 1.)

## FINAL PROOF SURVEY UNDER

Application No. G-8607. Permit No. G-8916.  
IN NAME OF

JAMES W. GILBERT

Surveyed OCT. 3. 1978, by G. L. HUGHES.

**RECEIVED**

AUG 18 2008

WATER RESOURCES DEPT  
SALEM, OREGON