

T.28S. R.4W.W.M.

NE cor Sec 27  
30" Drive Shaft Housing

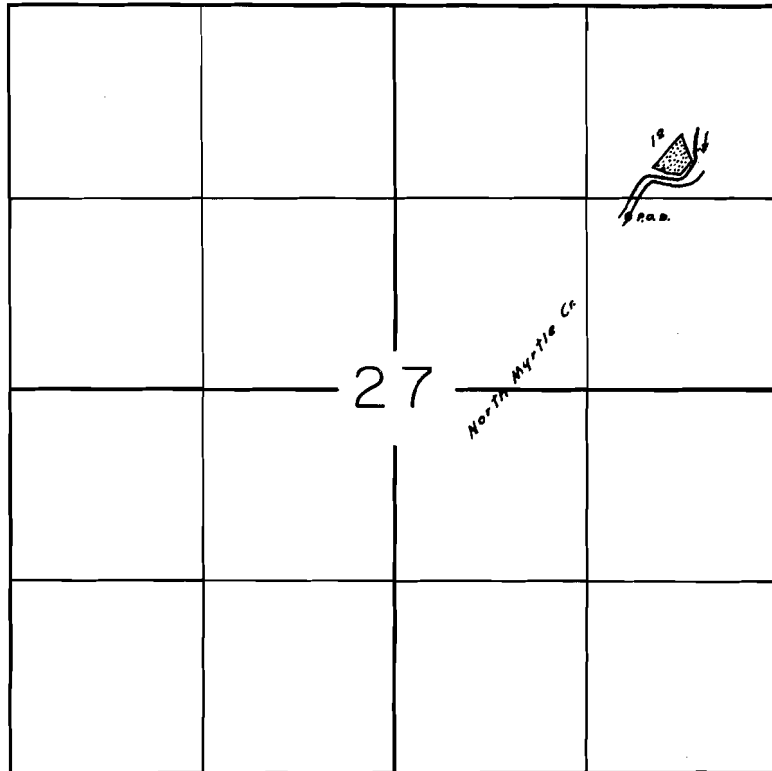

P.O. D. 1450 S, 1025 W from NE cor Sec. 27

**FINAL PROOF SURVEY**  
UNDER

Application No. 12636 Permit No. 8984  
IN NAME OF

Frank J. Roberts

Surveyed Mar. 3, 1969, by M. J. J.