

RECEIVED

OCT 13 2000

WATER RESOURCES DEPT.
SALEM, OREGON

FINAL PROOF SURVEY MAP
T29S, R3W, WM
SCALE 1" = 1320'
DOUGLAS COUNTY

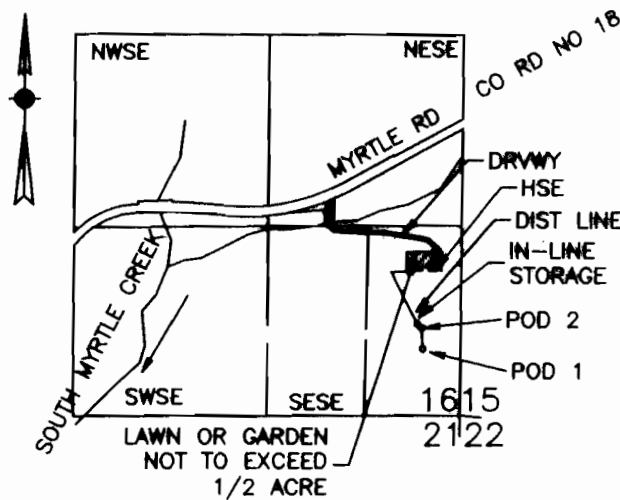

PODs
Referenced to SE
corner of section
16

POD 1 (SPRING) IS 460 FT N AND 260 FT W FROM SW COR SEC 16
POD 2 (SPRING) IS 600 FT N AND 260 FT W FROM SW COR SEC 16

FINAL PROOF SURVEY
UNDER

Application No. S-73730 Permit No. 52567

IN NAME OF

Stephen & Lois Lytsell

Surveyed September 18, 2000 by M E Farr

MAP PREPARED FOR:
STEPHEN & LOIS LYTSELL
13905 SOUTH MYRTLE ROAD
MYRTLE CREEK, OR 97457

MAP PREPARED BY:
MAURICE E FARR, CWRE
395 NE KIRBY AVENUE
ROSEBURG, OR 97470

THIS IS A LOCATION MAP FOR A FINAL PROOF SURVEY BY STEPHEN & LOIS LYTSELL. THIS MAP IS FOR THE PURPOSE OF IDENTIFYING THE LOCATION OF THE WATER RIGHT ONLY AND IS NOT INTENDED TO PROVIDE LEGAL DIMENSIONS OR LOCATIONS OF PROPERTY OWNERSHIP LINES.

