

EAGLE CREST RESORT
CLAIM OF BENEFICIAL USE
QUASI - MUNICIPAL WATER RIGHTS
PERMIT G-13856
MAY, 2006
(UPDATED JULY, 2008)

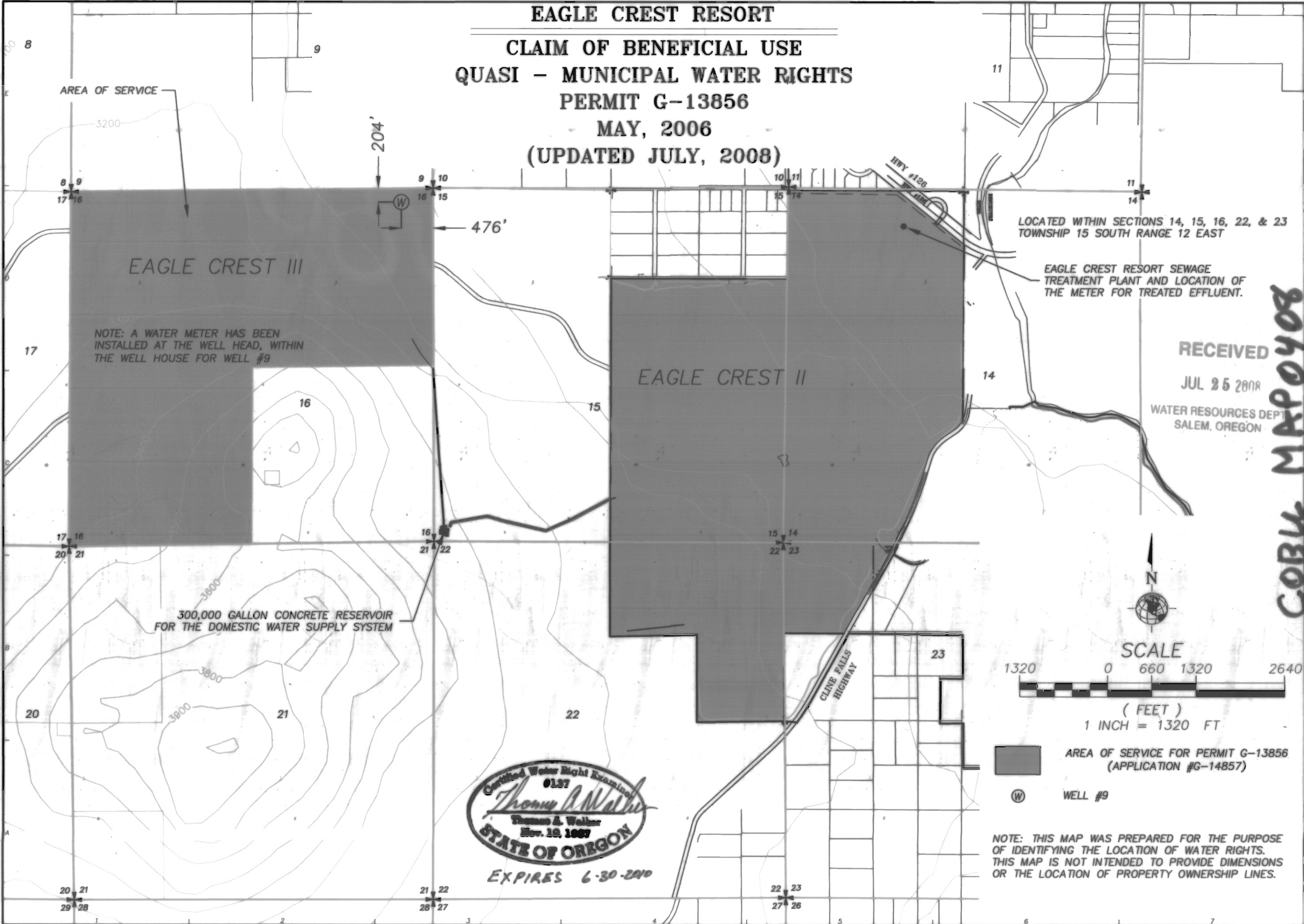

NOTE: A WATER METER HAS BEEN INSTALLED AT THE WELL HEAD, WITHIN THE WELL HOUSE FOR WELL #9

300,000 GALLON CONCRETE RESERVOIR FOR THE DOMESTIC WATER SUPPLY SYSTEM

LOCATED WITHIN SECTIONS 14, 15, 16, 22, & 23 TOWNSHIP 15 SOUTH RANGE 12 EAST

EAGLE CREST RESORT SEWAGE TREATMENT PLANT AND LOCATION OF THE METER FOR TREATED EFFLUENT.

RECEIVED
 JUL 25 2008

WATER RESOURCES DEPT
 SALEM, OREGON

Certified Water Right Examiner
 0137
Thomas A. Walker
 Thomas A. Walker
 Nov. 19, 1987
 STATE OF OREGON
 EXPIRES 6-30-2010

■ AREA OF SERVICE FOR PERMIT G-13856 (APPLICATION #G-14857)
 ⊙ WELL #9

NOTE: THIS MAP WAS PREPARED FOR THE PURPOSE OF IDENTIFYING THE LOCATION OF WATER RIGHTS. THIS MAP IS NOT INTENDED TO PROVIDE DIMENSIONS OR THE LOCATION OF PROPERTY OWNERSHIP LINES.

WHPacific
 820 SW Emory Dr
 Bend, OR 97702
 541-388-4255 Fax 541-388-4229
 www.whpacific.com

CLINE BUTTE UTILITY COMPANY
GROUNDWATER PERMIT AMENDMENT
APPLICATION MAP
 APPLICATION: G-14857 PERMIT: G-13856
 PROJECT NO. 031250
 DRAWING FILE NAME: EAGLE CREST h2o RIGHTS.DWG
 OREGON

COBL MAP0408

CHECKED BY:	TW
APPROVED BY:	SKS
DATE:	5/22/2008
REVISION:	CK/D/APP