

THIS MAP WAS PREPARED FOR THE PURPOSE OF IDENTIFYING THE LOCATION OF THE WATER RIGHT AND IS NOT INTENDED TO PROVIDE LEGAL DIMENSIONS OR LOCATIONS OF PROPERTY OWNERSHIP LINES.

T3N, R1W

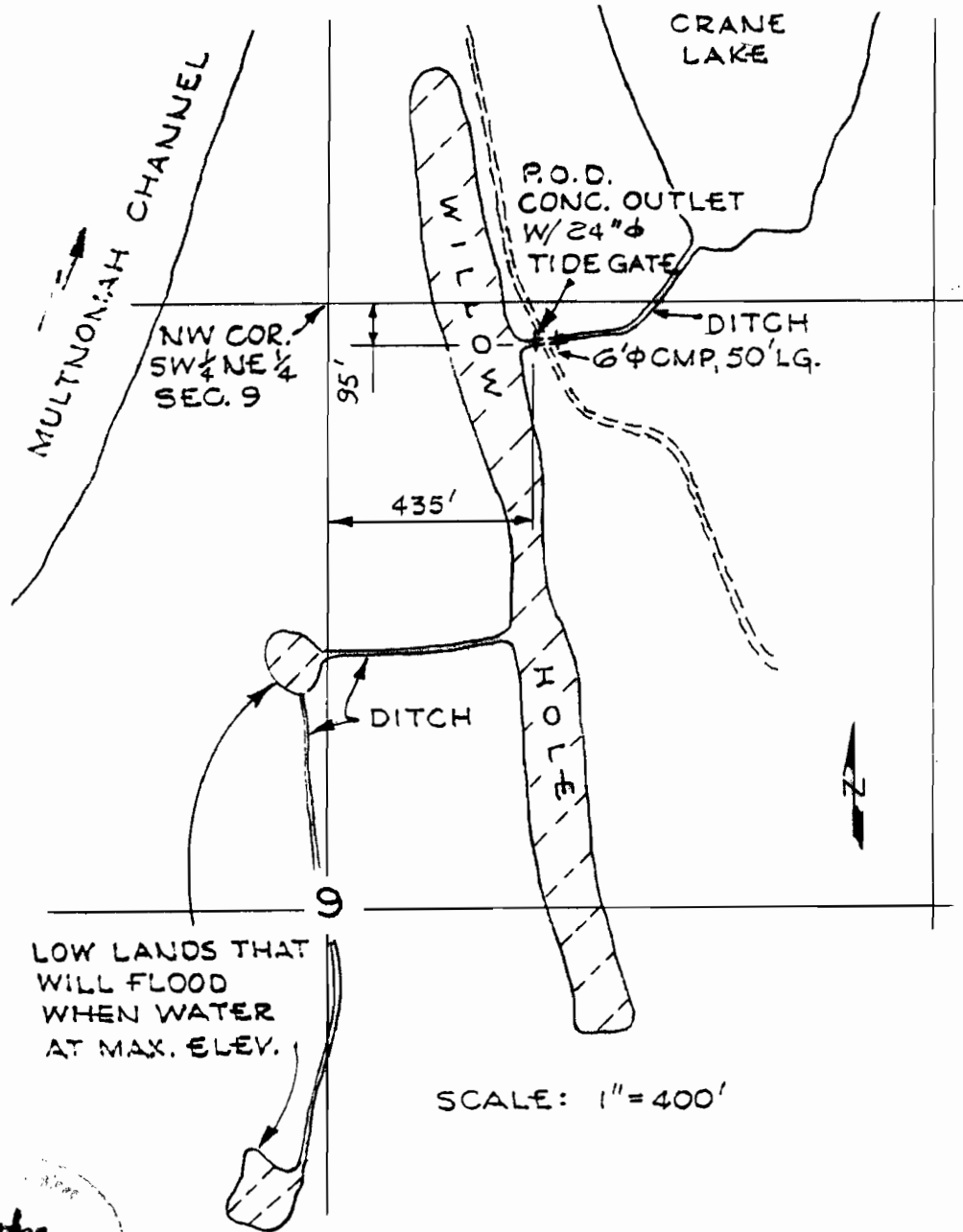

Robert O. Dodge  
ROBERT O. DODGE  
NOV 15 1997  
STATE OF OREGON

**FINAL PROOF SURVEY  
UNDER**

APPLICATION NO. R-71307 PERMIT NO. 51620

IN NAME OF

**OREGON DEPARTMENT OF FISH AND WILDLIFE**

SURVEYED: 6/21/96 BY: DODGE