

# T.6S. R.1E. Sec. 8 and 9

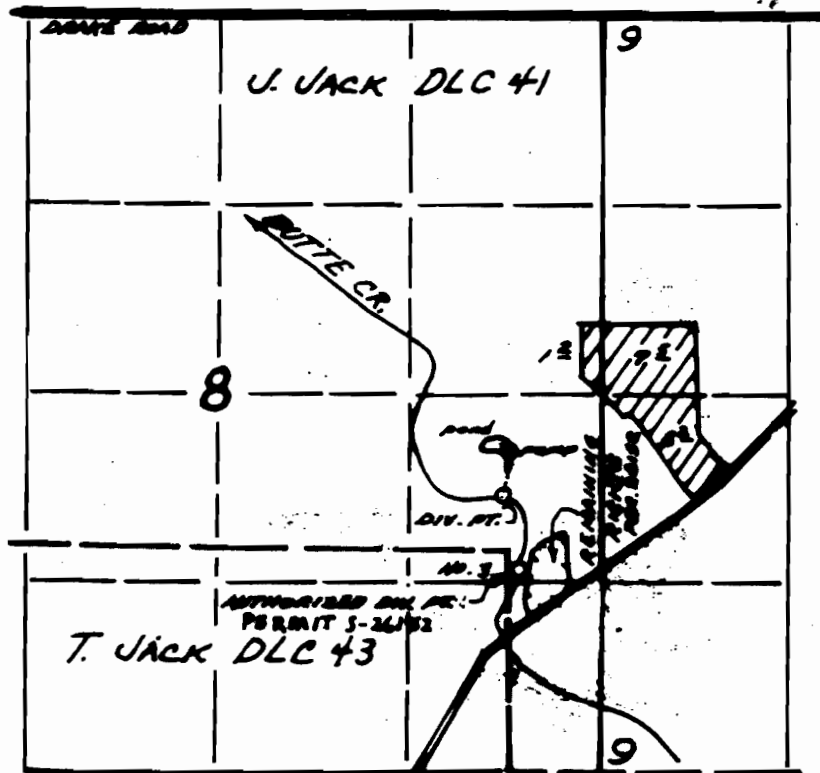

Diversion Point for T-6917 is located 1,930 feet north and 690 feet west of the southeast corner of Section 8.

Diversion Point for remaining water right Permit S-26152 is located 1420 feet north and 575 feet west of the southeast corner of Section 8.

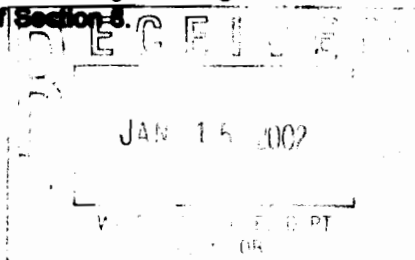

Area (14.9 Acres) irrigated under T-6917

EXPIRATION DATE: 6/30/2003

Scale: 1" = 1,320'



0 1,320 Feet

This map was prepared for the purpose of identifying the location of a water right only and is not intended to provide legal dimensions or location of property ownership lines.



## Water Right Transfer Claim of Beneficial Use Map

Transfer No. 6917

Wilbur Vanderbeck

T.6S. R.1E. Sec. 8 and 9

Pacific Hydro-Geology Inc.

# T.6S. R.1E. Sec. 8 and 9

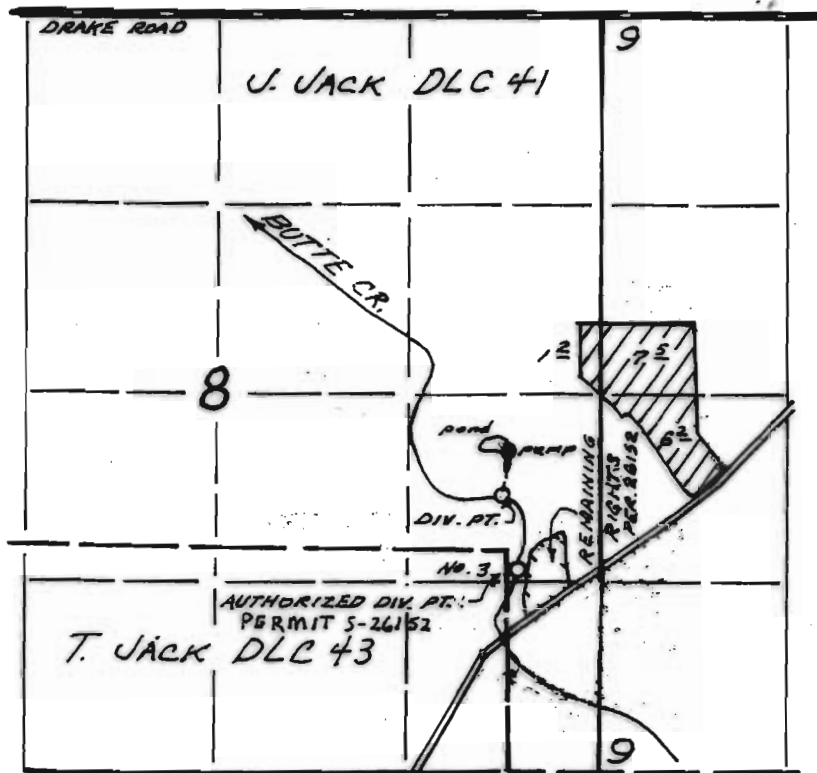

Diversion Point for T-6917 is located 1,930 feet north and 680 feet west of the southeast corner of Section 8.

Diversion Point for remaining water right Permit S-26152 is located 1420 feet north and 575 feet west of the southeast corner of Section 8.

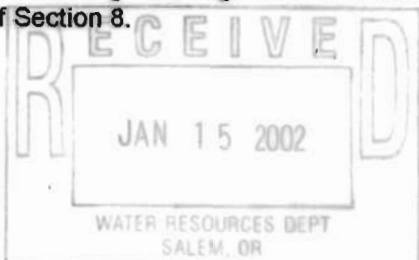

 Area (14.9 Acres) irrigated under T-6917

EXPIRATION DATE: 6/30/2003

Scale: 1" = 1,320'



This map was prepared for the purpose of identifying the location of a water right; only and is not intended to provide legal dimensions; or location of property ownership lines.



## Water Right Transfer Claim of Beneficial Use Map

Transfer No. 6917

Wilbur Vanderbeck

T.6S. R.1E. Sec. 8 and 9

Pacific Hydro-Geology Inc.