

T. 8S., R. 19E., W. M.

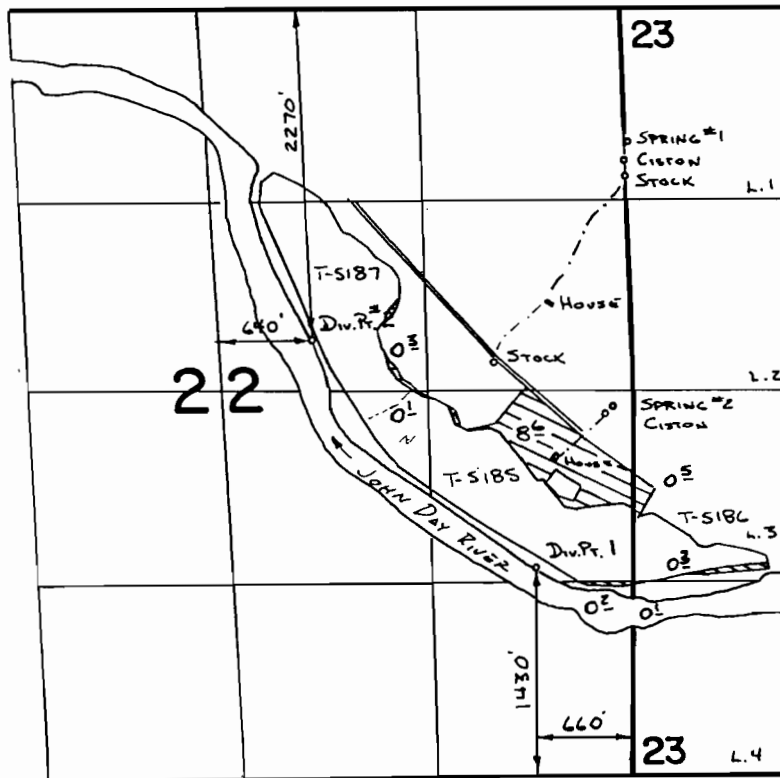
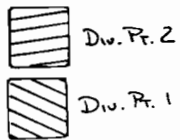

SCALE 1" = 1320'

SPRING #1 Loc: 920'S. & 20'E. FROM NW. COR. SEC. 23
 SPRING #2 Loc: 100'S. & 140'W. FROM E 1/4 COR SEC 22

FINAL PROOF SURVEY
UNDER

TRANSFERS 5185, 5186, 5187
 Application No. **64524**, Permit No. **47231**....
 IN NAME OF

.....**JON BOWERMAN**.....

Surveyed 5-12 1987, by V.L. Church.....

T. 8 S., R. 19 E., W.M.
 APPLICATION MAP FOR
 JON BOWERMAN

Jon Bowerman

RECEIVED
 JAN 17 1983
 WATER RESOURCES DEPT.
 SALEM, OREGON

RECEIVED
 NOV 29 1982
 WATER RESOURCES DEPT.
 SALEM, OREGON

T-5185

APPROVED

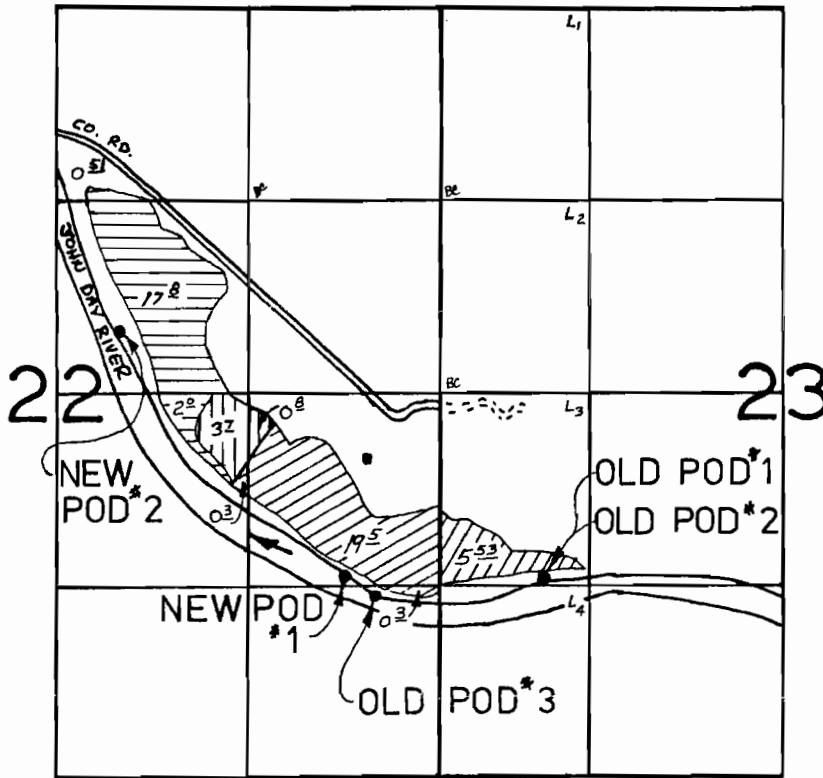

SCALE
 4" = 1 mi

OLD POD#1: 1370 ft N & 700 ft E of SW cor Sec. 23
 OLD POD#2: 1270 ft S & 682 ft E of W 1/4 cor Sec. 23
 OLD POD#3: 1350 ft S & 450 ft W of E 1/4 cor Sec. 22
 all T8S, R19E, WM.

	C-31299
	C-25129
	C-25129
	C-12191

FROM OLD POD	TO NEW POD
#1	#2
#3	#2
#3	#1
#2	#1

NEW POD#1: 1250 ft S & 650 ft W of E 1/4 cor Sec. 22
 NEW POD#2: 420 ft N & 2200 ft W of E 1/4 cor Sec. 22
 both T8S, R19E, WM

Application No. 64524
 Permit No.

RECEIVED
 NOV 4 1982
 WATER RESOURCES DEPT.
 SALEM, OREGON